

Erweitertes Ganzaluminium Türsystem ohne Rauchschutz Amplified Non Thermal Broken Door System without Smoke Control

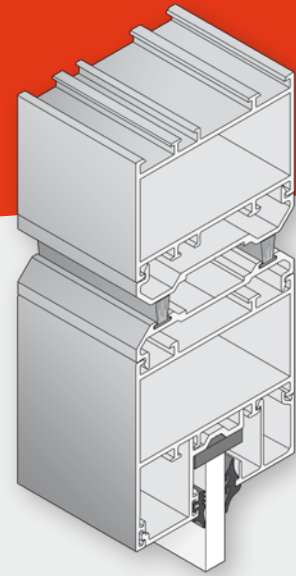

Güteprüfungen Performance

Luftdurchlässigkeit <i>Air Permeability</i>	DIN EN 12207 <i>DIN EN 12207</i>
Bedienkräfte <i>Operating Forces</i>	DIN EN 13115 <i>DIN EN 13115</i>
Tragfähigkeit von Sicherheitsvorrichtungen <i>Load-bearing Capacity of Safety Devices</i>	Anforderungen erfüllt <i>Meets Requirements</i>
Qualitätsmanagementsysteme <i>Quality Management Systems</i>	Zertifiziert nach DIN EN ISO 9001 <i>Certified according to DIN EN ISO 9001</i>

Bauarten Construction Types

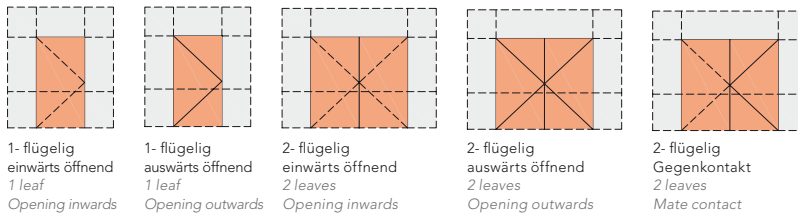

Innenelemente
Interior Elements

AA 611

Rahmen/Flügel Standard

- ▶ Mittenverglasung
- ▶ 1-flg. oder 2-flg. einwärts öffnend

Frame/Leaf Standard

- ▶ Central glazing
- ▶ 1 or 2 leaves opening inwards

AA 611

Rahmen/Flügel Standard

- ▶ Mittenverglasung
- ▶ 1-flg. oder 2-flg. auswärts öffnend

Frame/Leaf Standard

- ▶ Central glazing
- ▶ 1 or 2 leaves opening outwards

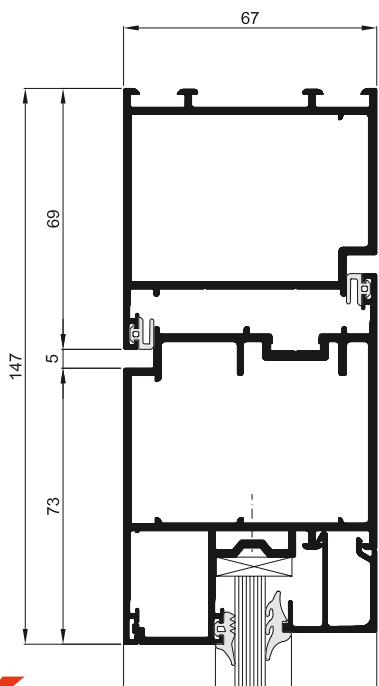

AA 611
Optional
Standardverglasung
Optional
Standard Glazing

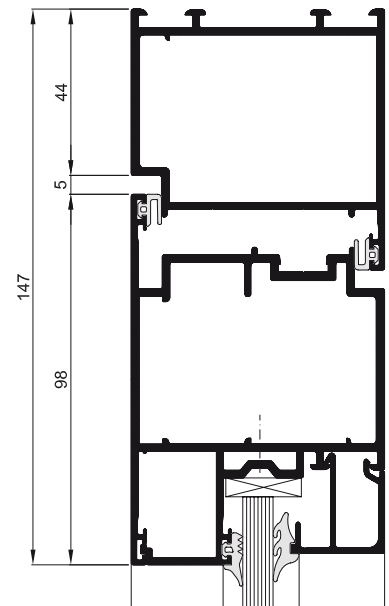
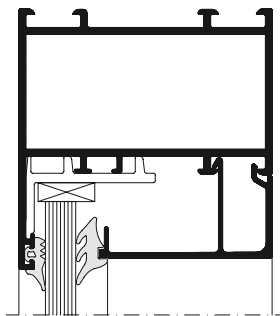

AA 611

Sockel – Standard

- ▶ einwärts/auswärts öffnend
- ▶ Deckplatte und Bodentürschließer

Base – Standard

- ▶ opening inwards/outwards
- ▶ cover plate and floor door closers

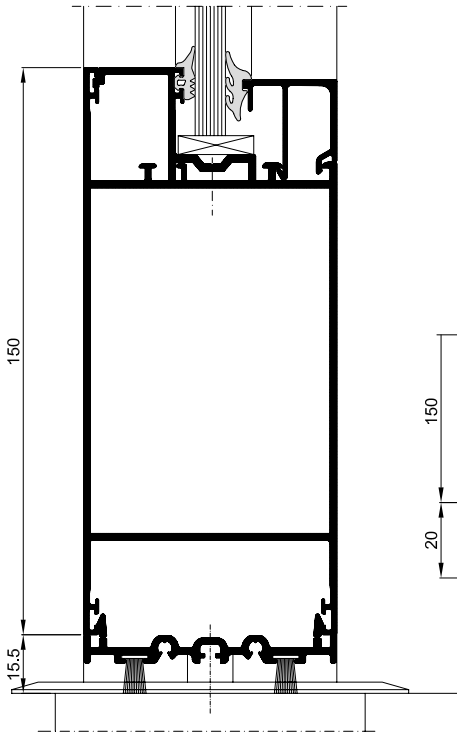

AA 611

Sockel – Standard

- ▶ Seitenteil feststehend
- Base – Standard**
- ▶ lateral part fixed

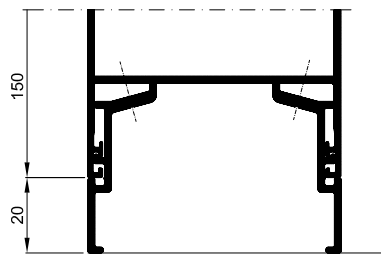

AA 611

Sockel – Standard

- ▶ einwärts öffnend
- ▶ optional mit Trägerprofil

Base – Standard

- ▶ opening inwards
- ▶ optional with carrier profile

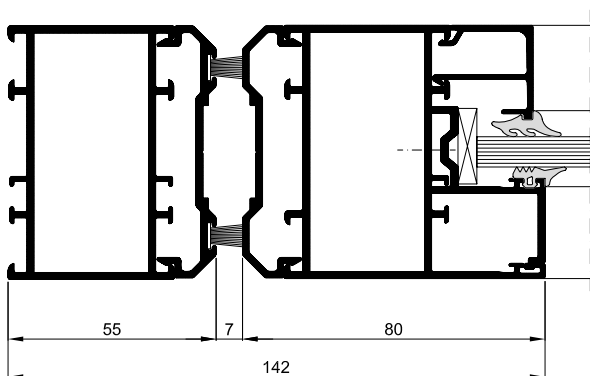
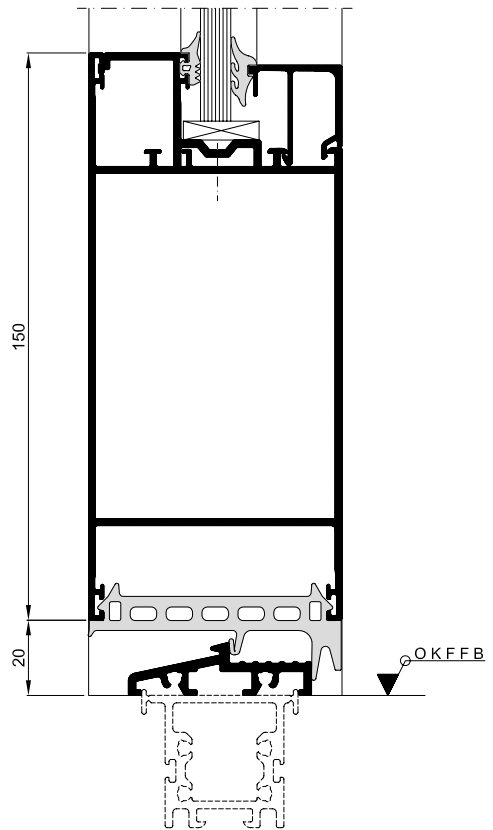

AA 611

Pendeltür

- Rahmen/Aufnahme-
profile/Flügel
- Swinging Door**
- frame/rest profile/
leaf

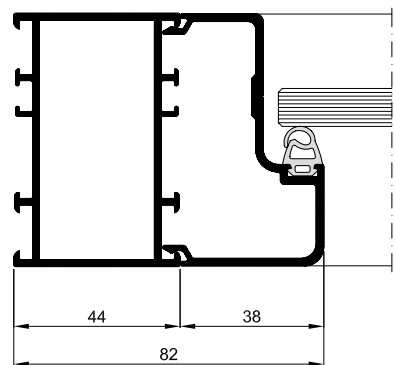

Bauarten
Construction Types

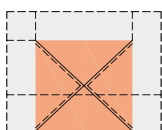

2-flügelige
Pendeltür
2 leaves
swinging door

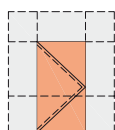

1-flügelige
Pendeltür
1 leaf
swinging door



1-flügelige
Ganzglastür
1 leaf full-
glazed door

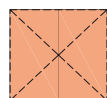

2-flügelige
Ganzglastür
2 leaves full-glazed
door

AA 611

Ganzglas einwärts öffnend

- Rahmen/Anschlag
- Full Glazed Opening Inward**
- frame/stopper