

Features

- System depth of 4-1/2" (114.3)
- Available as OX, XO, OXO and OXXO configurations, common mullion allows for additional fixed lites to be stacked (OOX and XOO)
- Infill range from 1/4" (6.4) to 1" (25.4)
- Heavy duty steel ball-bearing, tandem roller assembly
- Stainless steel track insert for sliding panels
- Corrosion-resistant stainless steel locks and fasteners
- Permanodic™ anodized finishes in seven choices
- Painted finishes in standard and custom choices

Optional Features

- Expansion mullion allows for multiple units to be stacked
- Horizontal cross rails available
- Optional interior insect screens available

Product Applications

- The 990 Sliding Door is designed for low to high rise applications for use in condominiums, hotel and apartments

Laws and building and safety codes governing the design and use of glazed entrance, window, and curtain wall products vary widely. Kawneer does not control the selection of product configurations, operating hardware, or glazing materials, and assumes no responsibility therefor.

Kawneer reserves the right to change configuration without prior notice when deemed necessary for product improvement.
© Kawneer Company, Inc., 2010

Laws and building and safety codes governing the design and use of glazed entrance, window, and curtain wall products vary widely. Kawneer does not control the selection of product configurations, operating hardware, or glazing materials, and assumes no responsibility therefor.

Kawneer reserves the right to change configuration without prior notice when deemed necessary for product improvement.

© Kawneer Company, Inc., 2010

TYPICAL DETAILS 4, 5
SCREEN DETAILS 6
GLAZING OPTIONS 6
HARDWARE OPTIONS 7, 8
WIND LOAD CHARTS..... 9

Laws and building and safety codes governing the design and use of glazed entrance, window, and curtain wall products vary widely. Kawneer does not control the selection of product configurations, operating hardware, or glazing materials, and assumes no responsibility therefor.

Kawneer reserves the right to change configuration without prior notice when deemed necessary for product improvement.
© Kawneer Company, Inc., 2010

LAWS AND BUILDING AND SAFETY CODES GOVERNING THE DESIGN AND USE OF GLAZED ENTRANCE, WINDOW, AND CURTAIN WALL PRODUCTS VARY WIDELY. KAWNEER DOES NOT CONTROL THE SELECTION OF PRODUCT CONFIGURATIONS, OPERATING HARDWARE, OR GLAZING MATERIALS, AND ASSUMES NO RESPONSIBILITY THEREFOR.

Metric (SI) conversion figures are included throughout these details for reference. Numbers in parentheses () are millimeters unless otherwise noted.

The following metric (SI) units are found in these details:

- m – meter
- cm – centimeter
- mm – millimeter
- s – second
- Pa – pascal
- MPa – megapascal

Kawneer reserves the right to change configurations without prior notice when deemed necessary for product improvement.

SCALE 3" = 1'-0"

TYPICAL ELEVATIONS

ELEVATIONS ARE NUMBER KEYED TO DETAILS ON THE FOLLOWING PAGES

Note: Elevations shown with "Sub-Sash" framing in the fixed lite.

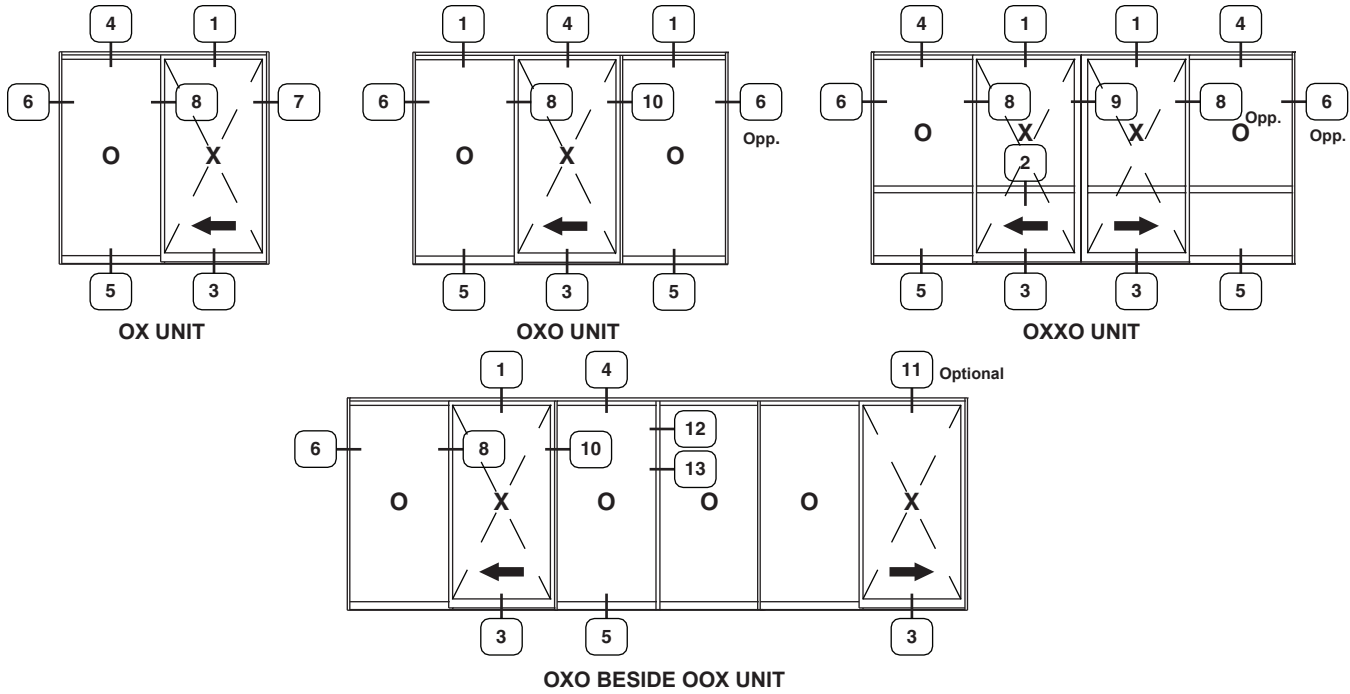

Note: 1/4" infill shown. See Glazing Options for other infills.

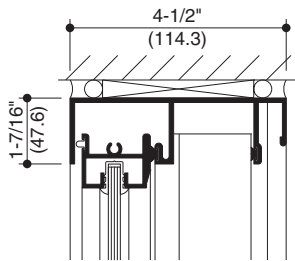

1 HEAD AT SLIDING PANEL

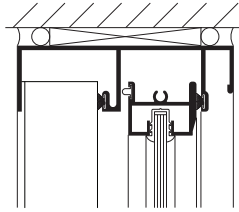

4 HEAD AT FIXED PANEL

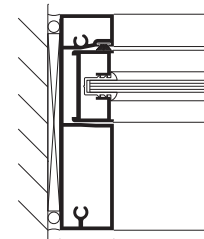

6 JAMB AT FIXED PANEL

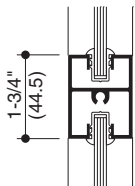

2 OPTIONAL HORIZONTAL AT SLIDING PANEL

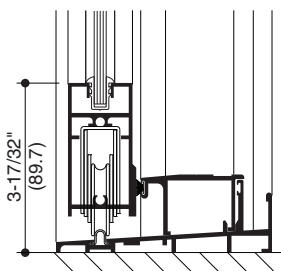

3 SILL AT SLIDING PANEL

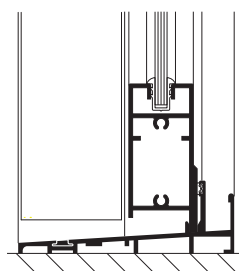

5 SILL AT FIXED PANEL

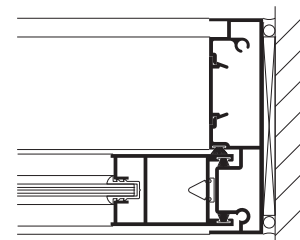

7 JAMB AT SLIDING PANEL

Local, building and safety codes governing the design and use of glazed entrance, window, and curtain wall products vary widely. Kawneer does not control the selection of product configurations, operating hardware, or glazing materials, and assumes no responsibility therefor.

Kawneer reserves the right to change configuration without prior notice when deemed necessary for product improvement.
© Kawneer Company, Inc., 2010

SCALE 3" = 1'-0"

Laws and building and safety codes governing the design and use of glazed entrance, window, and curtain wall products vary widely. Kawneer does not control the selection of product configurations, operating hardware, or glazing materials, and assumes no responsibility therefor.

Kawneer reserves the right to change configuration without prior notice when deemed necessary for product improvement.
© Kawneer Company, Inc., 2010

8 INTERLOCK STILE

9 OXXO MEETING STILES

10 LOCK STILE MULLION WITH 1848 LOCK

STANDARD RANGE

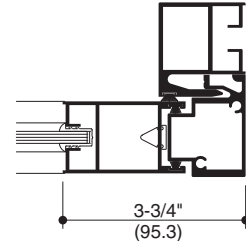
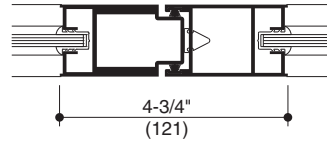
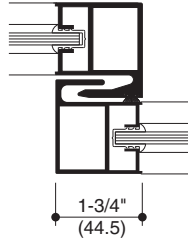

MID-RANGE

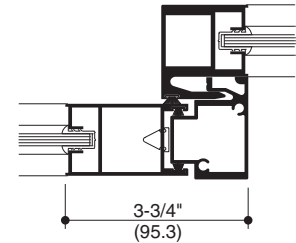
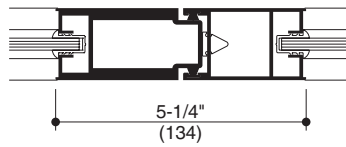
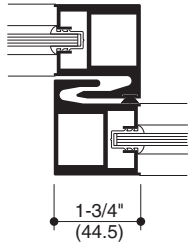

MAXIMUM RANGE

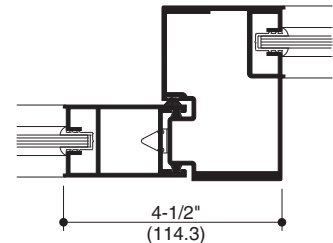
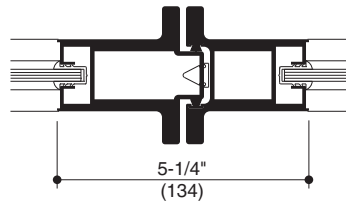
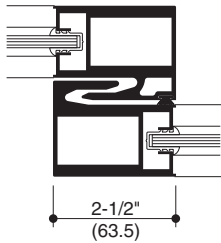

OPTIONAL MEMBERS

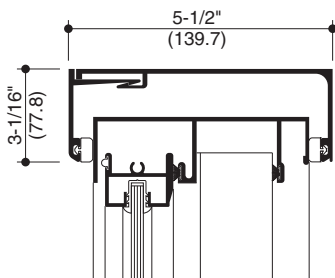

11 HEAD RECEPTOR

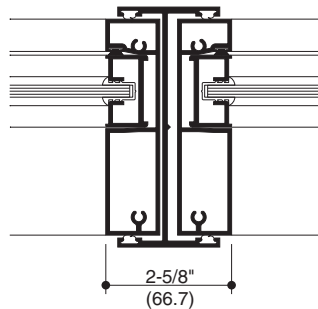

12 EXPANSION MULLION

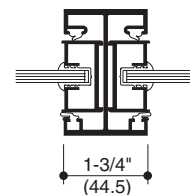

13 FIXED STILE MULLION

SCALE 3" = 1'-0"

TYPICAL SCREEN DETAILS

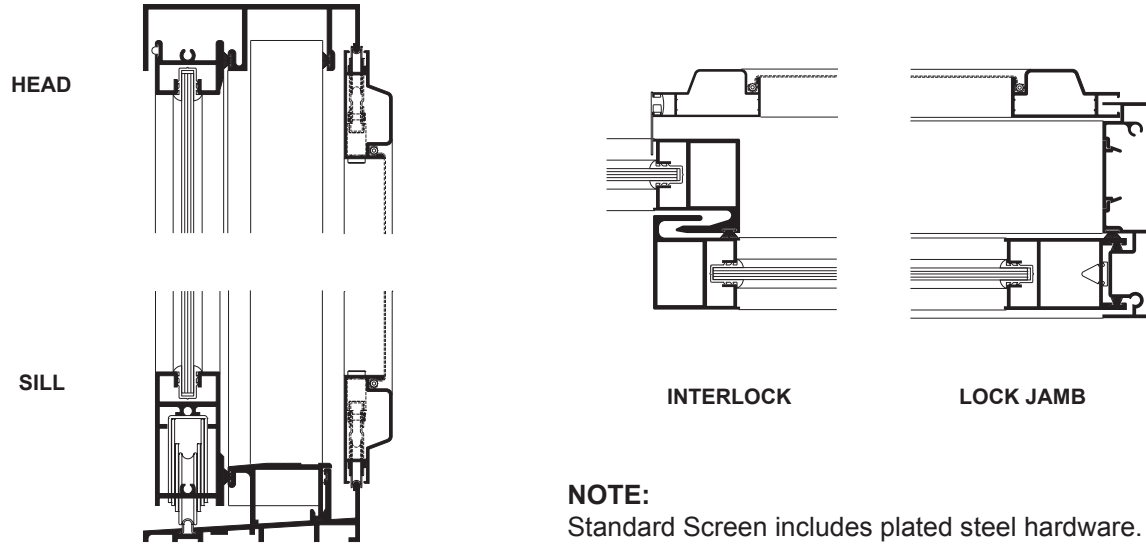

NOTE:
Standard Screen includes plated steel hardware.
Optional Screen available with stainless steel hardware.

INFILL OPTIONS

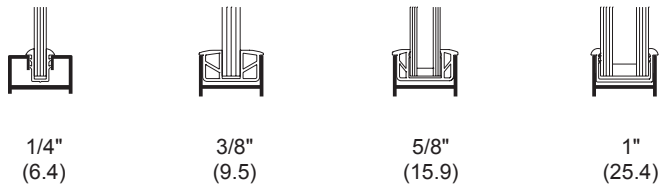

STANDARD CASTER

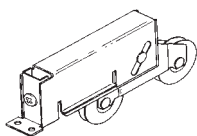





BUMPER

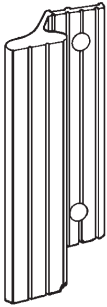
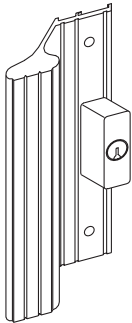
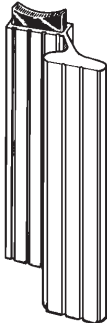
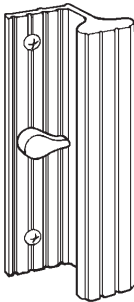

Laws and building and safety codes governing the design and use of glazed entrance, window, and curtain wall products vary widely. Kawneer does not control the selection of product configurations, operating hardware, or glazing materials, and assumes no responsibility therefor.

Kawneer reserves the right to change configuration without prior notice when deemed necessary for product improvement.
© Kawneer Company, Inc., 2010



1-Point Lock	Handles	Exterior	Option	Interior	Option
	Extruded Pulls	Blank (Std)	1	Slide Operator (Std)	3
		Blank	1	Thumbturn	4
		Basic Cylinder (5/8")	2	Thumbturn	4
	Flush Pulls	Blank	5	Slide Operator	7
		Basic Cylinder (5/8")	6	Slide Operator	7

EXTERIOR HANDLES		INTERIOR HANDLES	
Extruded Pulls			
 <p>Option 1</p> <p>Blank Pull (Standard)</p>	 <p>Option 2</p> <p>Basic Cylinder (5/8") Pull</p>	 <p>Option 3</p> <p>Slide Operator Pull (Standard)</p>	 <p>Option 4</p> <p>Thumb Pull</p>
Flush Pulls			
 <p>Option 5</p> <p>Blank Pull</p>	 <p>Option 6</p> <p>Basic Cylinder (5/8") Pull</p>	 <p>Option 7</p> <p>Slide Operator Pull</p>	

Laws and building and safety codes governing the design and use of glazed entrance, window, and curtain wall products vary widely. Kawneer does not control the selection of product configurations, operating hardware, or glazing materials, and assumes no responsibility therefor.

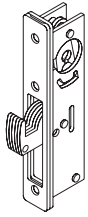
Kawneer reserves the right to change configuration without prior notice when deemed necessary for product improvement.
© Kawneer Company, Inc., 2010

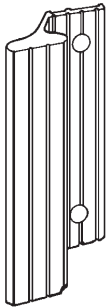
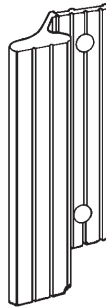
MS Hook Bolt Lock	Handles	Exterior	Option	Interior	Option
	Extruded Pulls	Blank	1	Blank	1
		Mortise Cylinder	9	Mortise Cylinder	9
		Blank	1	Blank	1
		Mortise Cylinder	9	Thumbturn	10
		Blank	1	Blank	1
		---	---	Thumbturn	10
		Blank	1	Blank	1
		---	---	Mortise Cylinder	9
	Flush Pulls	Blank	5	Blank	8
		Mortise Cylinder	9	Mortise Cylinder	9
		Blank	5	Blank	5
		Mortise Cylinder	9	Thumbturn	10
		Blank	5	Blank	5
		---	---	Thumbturn	10
Blank	5	Blank	5		
---	---	Mortise Cylinder	9		

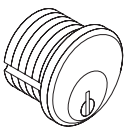
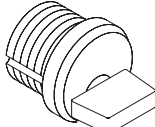
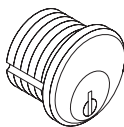
EXTERIOR HANDLES		INTERIOR HANDLES	
Extruded Pulls  Option 1 Blank Pull		 Option 1 Blank Pull	
Flush Pulls  Option 5 Blank Pull		 Option 8 Blank Pull	
EXTERIOR		INTERIOR	
 Option 9 Mortise Cylinder		  Option 10 Thumbturn Option 9 Mortise Cylinder	

Laws and building and safety codes governing the design and use of glazed entrance, window, and curtain wall products vary widely. Kawneer does not control the selection of product configurations, operating hardware, or glazing materials, and assumes no responsibility therefor.

Kawneer reserves the right to change configuration without prior notice when deemed necessary for product improvement.
© Kawneer Company, Inc., 2010

WIND LOAD CHARTS ARE BASED ON CRITERIA SET FORTH IN AAMA 101-88 VOLUNTARY SPECIFICATION FOR ALUMINUM PRIME WINDOWS AND SLIDING GLASS DOORS. STRUCTURAL CRITERIA IS NO PERMANENT DEFORMATION OF ANY FRAME OR PANEL IN EXCESS OF 0.4% OF ITS SPAN. FOR SPECIAL SITUATIONS NOT COVERED BY THESE CHARTS, CONTACT YOUR KAWNEER REPRESENTATIVE FOR ADDITIONAL INFORMATION.

Laws and building and safety codes governing the design and use of glazed entrance, window, and curtain wall products vary widely. Kawneer does not control the selection of product configurations, operating hardware, or glazing materials, and assumes no responsibility therefor.

Kawneer reserves the right to change configuration without prior notice when deemed necessary for product improvement.
© Kawneer Company, Inc., 2010

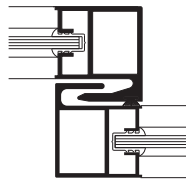
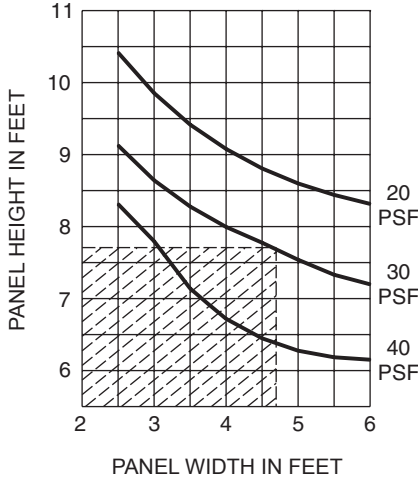

**590088 / 590015
STANDARD RANGE
INTERLOCKS**

590088
I = 0.434 (18.06 x 10⁴)
S = 0.430 (7.05 x 10³)
590015
I = 0.387 (16.11 x 10⁴)
S = 0.396 (6.49 x 10³)

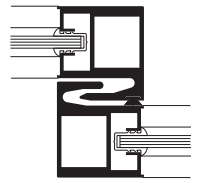
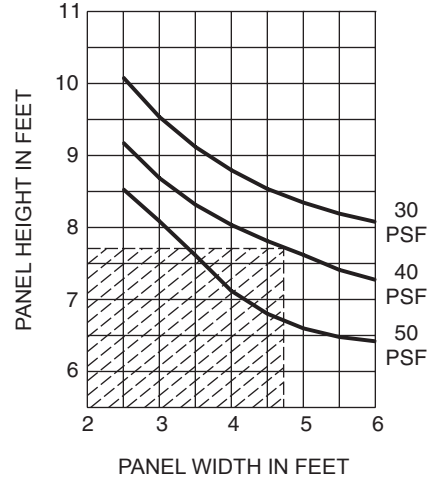

**590090 / 590017
MID-RANGE
INTERLOCKS**

590090
I = 0.572 (23.81 x 10⁴)
S = 0.565 (9.26 x 10³)
590017
I = 0.552 (22.98 x 10⁴)
S = 0.527 (8.64 x 10³)

STANDARD RANGE INTERLOCKS

UNITS WITHIN SHADED AREA WOULD BE CERTIFIED AAMA 101-88 C30 STANDARD COMMERCIAL SLIDER

MID-RANGE INTERLOCKS

UNITS WITHIN SHADED AREA WOULD BE CERTIFIED AAMA 101-88 HC40 HEAVY COMMERCIAL SLIDER

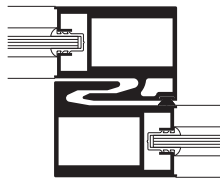
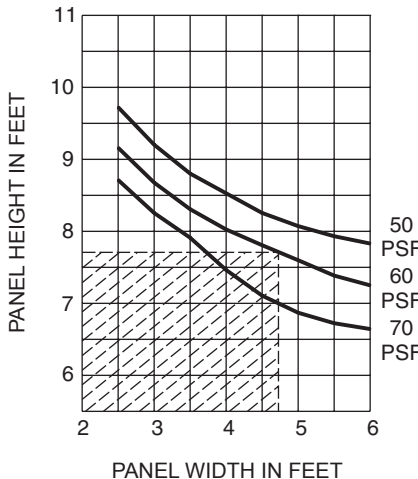

**590092 / 590019
MAXIMUM RANGE
INTERLOCKS**

590092
I = 0.839 (34.92 x 10⁴)
S = 0.821 (13.45 x 10³)
590019
I = 0.835 (34.75 x 10⁴)
S = 0.807 (13.23 x 10³)

NOTE: UNITS OUTSIDE OF SHADED AREA MEET AAMA 101-88 TEST CRITERIA, BUT WOULD NOT BE AAMA CERTIFIED, AS THEY ARE OF DIFFERENT SIZE THAN THAT OF UNIT TESTED. PANEL SIZE FOR TEST UNIT IS 4'-10" x 7'-8-1/2".

MAXIMUM RANGE INTERLOCKS

UNITS WITHIN SHADED AREA WOULD BE CERTIFIED AAMA 101-88 HC60 HEAVY COMMERCIAL SLIDER

Laws and building and safety codes governing the design and use of glazed entrance, window, and curtain wall products vary widely. Kawneer does not control the selection of product configurations, operating hardware, or glazing materials, and assumes no responsibility therefor.

Kawneer reserves the right to change configuration without prior notice when deemed necessary for product improvement.
© Kawneer Company, Inc., 2010