

Features

- 260 Insulclad® has 2-11/16" vertical stile, 2-13/16" top and 4-7/16" bottom rail
- 360 Insulclad® has 4-1/16" vertical stile, 4-1/16" top and 7-1/16" bottom rail
- 560 Insulclad® has 5-9/16" vertical stile, 5-9/16" top and 7-1/16" bottom rail
- Door is 2-1/4" deep
- Dual moment welded corner construction
- Door incorporates an extruded PVC thermal break
- Single acting
- Offset pivots, butt hinges or continuous geared hinge
- Surface mounted or concealed closers
- MS locks or Exit Device hardware
- Architects Classic push/pulls
- 1" infill
- Adjustable astragal utilizing pile weathering with polymeric fin at meeting stiles
- Sealair® bulb polymeric weatherstripping in door frames
- Permanodic® anodized finishes in seven choices
- Painted finishes in standard and custom choices

Optional Features

- Numerous push/pull finishes
- Variety of bottom rail and cross rails
- Two-color finish capability

Product Applications

- 260 Insulclad® – engineered for thermal efficiency in moderate traffic applications such as offices, stores and apartment buildings
- 360 Insulclad® – provides thermal efficiency and extra strength for schools, institutions and other high traffic applications.
- 560 Insulclad® – designed for thermal efficiency with a monumental visual statement for banks, libraries or buildings that experience heavy traffic conditions

For specific product applications,
Consult your Kawneer representative.

Laws and building and safety codes governing the design and use of glazed entrance, window, and curtain wall products vary widely. Kawneer does not control the selection of product configurations, operating hardware, or glazing materials, and assumes no responsibility therefor.

Kawneer reserves the right to change configuration without prior notice when deemed necessary for product improvement.

© Kawneer Company, Inc., 2011

Laws and building and safety codes governing the design and use of glazed entrance, window, and curtain wall products vary widely. Kawneer does not control the selection of product configurations, operating hardware, or glazing materials, and assumes no responsibility therefor.

Kawneer reserves the right to change configuration without prior notice when deemed necessary for product improvement.
© Kawneer Company, Inc., 2011

PICTORIAL VIEW 5

260 ENTRANCE DETAILS 6

360 ENTRANCE DETAILS 7

560 ENTRANCE DETAILS 8

OPTIONAL DOOR DETAILS 9

HARDWARE STANDARDS10, 11

THERMAL PERFORMANCE TEST DATA..... 12

WINDLOAD & DEADLOAD CHARTS 13

THERMAL CHARTS 14-23

LAWS AND BUILDING AND SAFETY CODES GOVERNING THE DESIGN AND USE OF GLAZED ENTRANCE, WINDOW, AND CURTAIN WALL PRODUCTS VARY WIDELY. KAWNEER DOES NOT CONTROL THE SELECTION OF PRODUCT CONFIGURATIONS, OPERATING HARDWARE, OR GLAZING MATERIALS, AND ASSUMES NO RESPONSIBILITY THEREFOR.

Metric (SI) conversion figures are included throughout these details for reference. Numbers in parentheses () are millimeters unless otherwise noted.

The following metric (SI) units are found in these details:

- m – meter
- cm – centimeter
- mm – millimeter
- s – second
- Pa – pascal
- MPa – megapascal

Kawneer reserves the right to change configurations without prior notice when deemed necessary for product improvement.

Laws and building and safety codes governing the design and use of glazed entrance, window, and curtain wall products vary widely. Kawneer does not control the selection of product configurations, operating hardware, or glazing materials, and assumes no responsibility therefor.

Kawneer reserves the right to change configuration without prior notice when deemed necessary for product improvement.

© Kawneer Company, Inc., 2011

Laws and building and safety codes governing the design and use of glazed entrance, window, and curtain wall products vary widely. Kawneer does not control the selection of product configurations, operating hardware, or glazing materials, and assumes no responsibility therefor.

Kawneer reserves the right to change configuration without prior notice when deemed necessary for product improvement.

© Kawneer Company, Inc., 2011

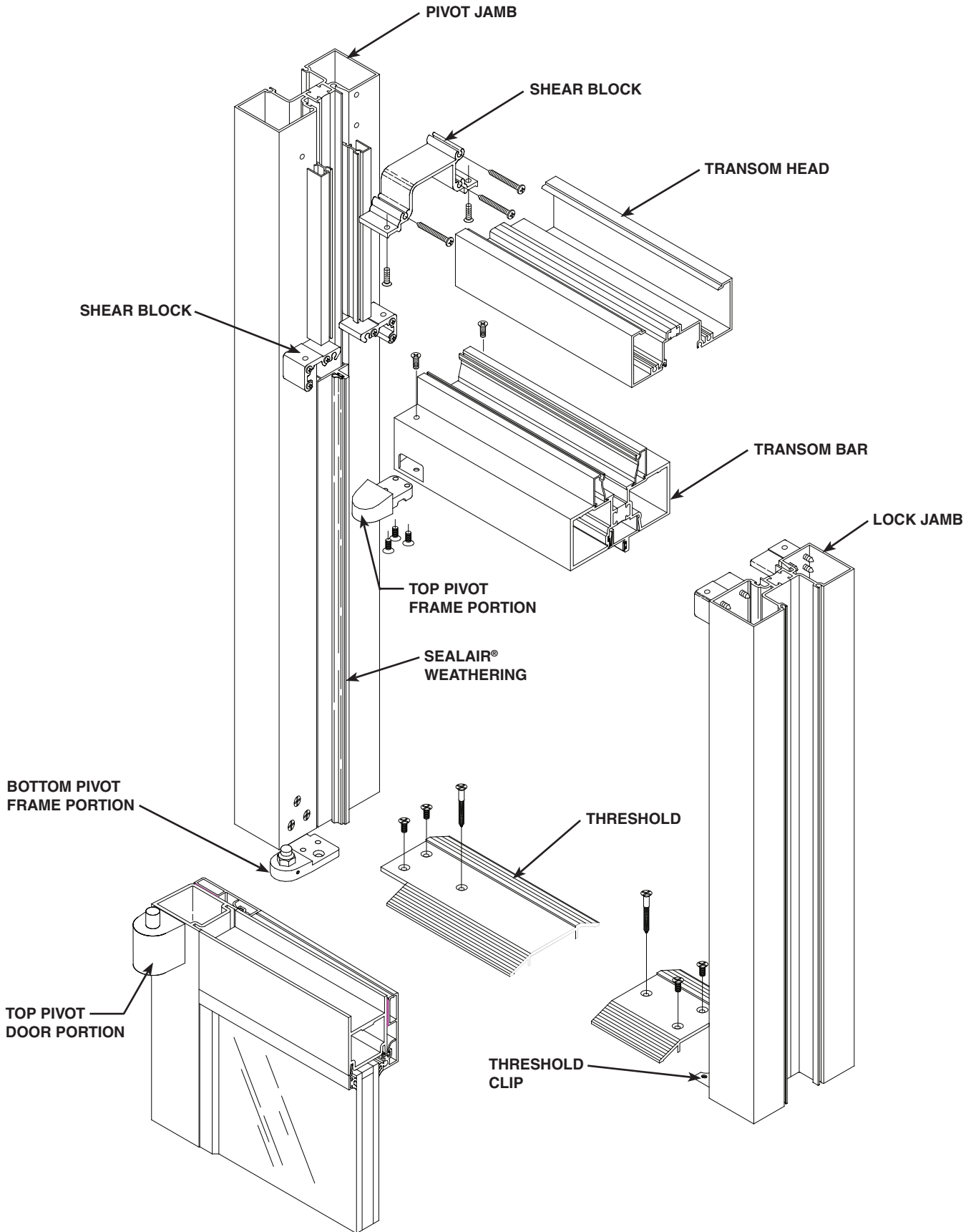

INSULCLAD® 260 DOOR

SCALE 3" = 1'-0"

TRIFAB® VG 451T CENTER FRAMING SHOWN.
OTHER FRAMING OPTIONS AVAILABLE.
CONSULT YOUR KAWNEER REPRESENTATIVE.

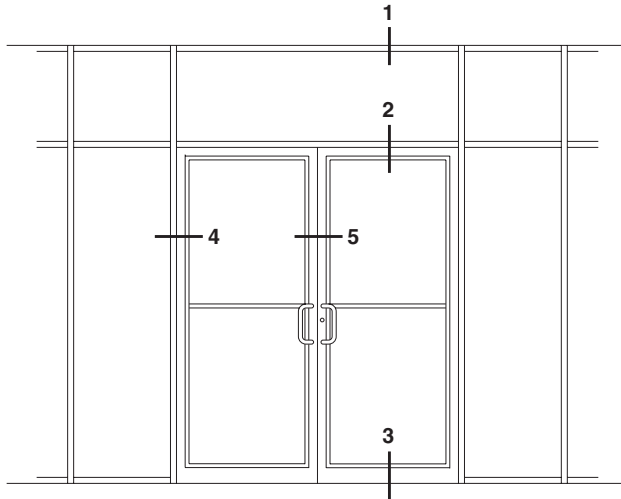

ELEVATION IS NUMBER KEYED TO DETAILS.

NOTE: Butt Hung or Offset Pivot Doors Only.

1 HEAD

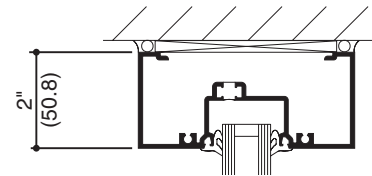

2 TRANSOM BAR

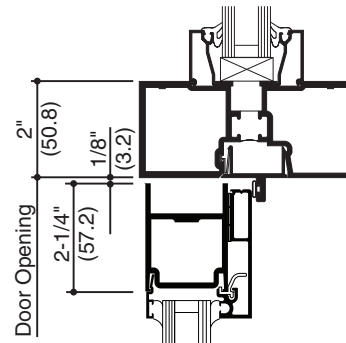

3 BOTTOM RAIL

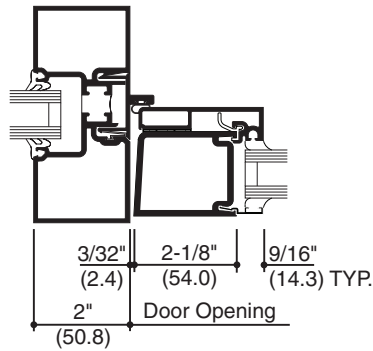
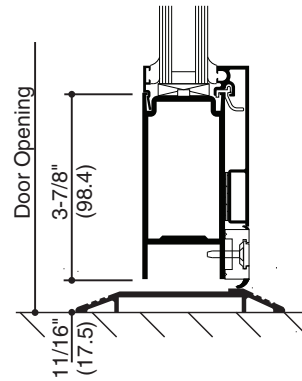

4 DOOR JAMB

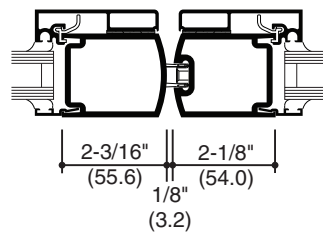

5 MEETING STILES

Laws and building and safety codes governing the design and use of glazed entrance, window, and curtain wall products vary widely. Kawneer does not control the selection of product configurations, operating hardware, or glazing materials, and assumes no responsibility therefor.

Kawneer reserves the right to change configuration without prior notice when deemed necessary for product improvement.
© Kawneer Company, Inc., 2011

260 INSULCLAD® DOOR

SCALE 3" = 1'-0"

TRIFAB® VG 451T CENTER FRAMING SHOWN. OTHER FRAMING OPTIONS AVAILABLE. CONSULT YOUR KAWNEER REPRESENTATIVE.

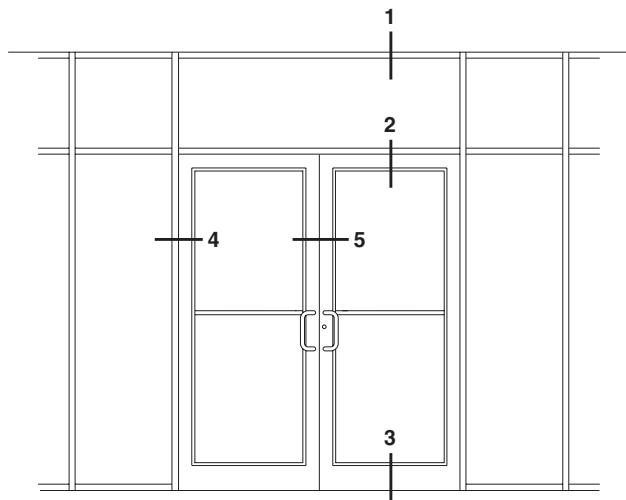

ELEVATION IS NUMBER KEYED TO DETAILS.

NOTE: Butt Hung or Offset Pivot Doors Only.

1 HEAD

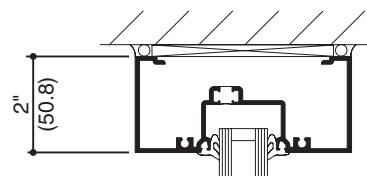

2 TRANSOM BAR

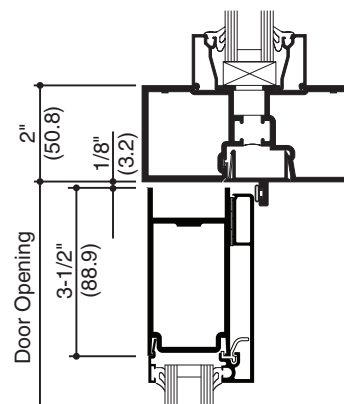

3 BOTTOM RAIL

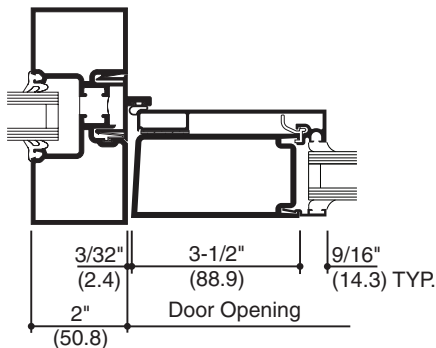
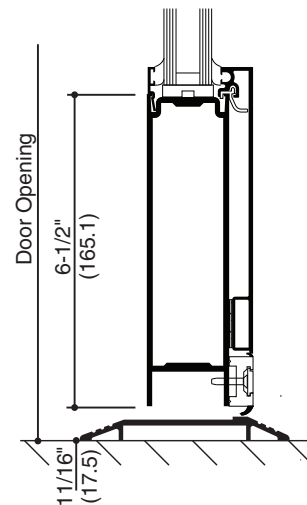

4 DOOR JAMB

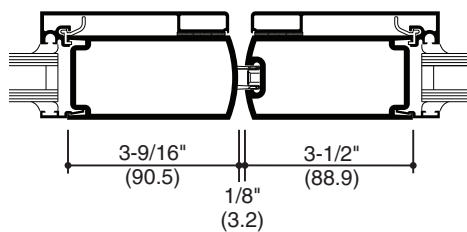

5 MEETING STILES

360 INSULCLAD® DOOR

Laws and building and safety codes governing the design and use of glazed entrance, window, and curtain wall products vary widely. Kawneer does not control the selection of product configurations, operating hardware, or glazing materials, and assumes no responsibility therefor.

Kawneer reserves the right to change configuration without prior notice when deemed necessary for product improvement.

© Kawneer Company, Inc., 2011

SCALE 3" = 1'-0"

TRIFAB® VG 451T CENTER FRAMING SHOWN.
OTHER FRAMING OPTIONS AVAILABLE.
CONSULT YOUR KAWNEER REPRESENTATIVE.

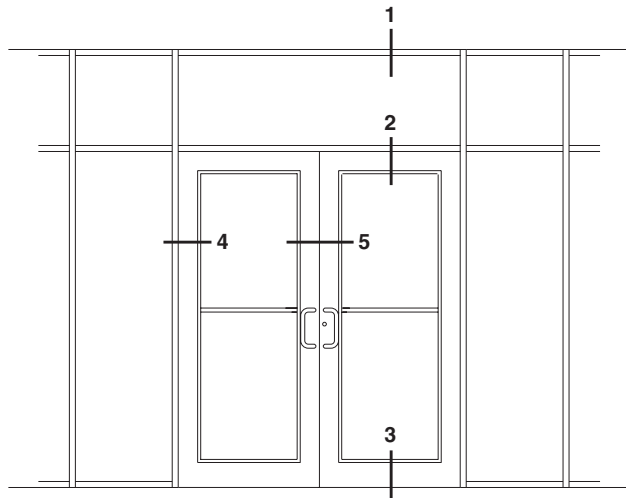

ELEVATION IS NUMBER KEYED TO DETAILS.

NOTE: Butt Hung or Offset Pivot Doors Only.

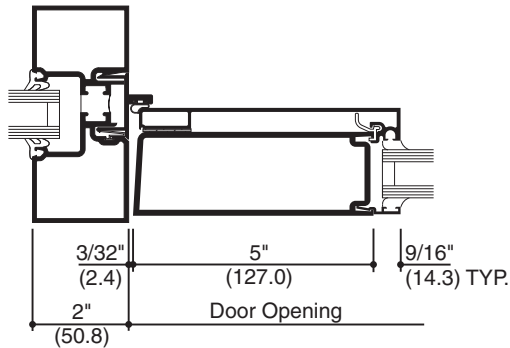

4
DOOR
JAMB

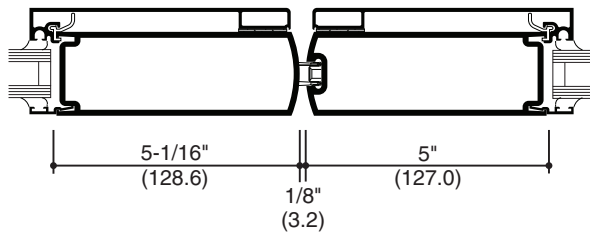

5
MEETING
STILES

1
HEAD

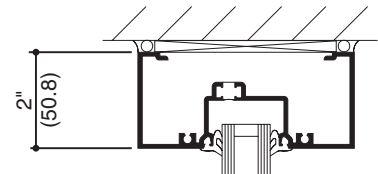

2
TRANSOM
BAR

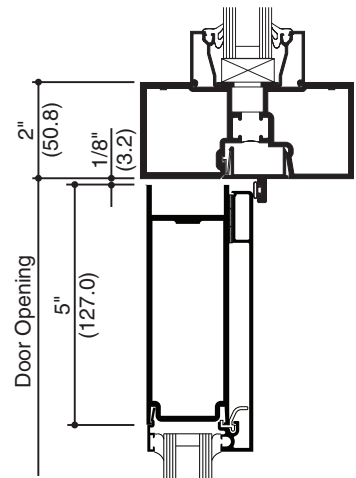

3
BOTTOM
RAIL

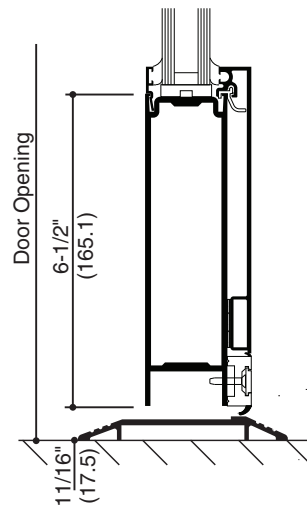

Laws and building and safety codes governing the design and use of glazed entrance, window, and curtain wall products vary widely. Kawneer does not control the selection of product configurations, operating hardware, or glazing materials, and assumes no responsibility therefor.

Kawneer reserves the right to change configuration without prior notice when deemed necessary for product improvement.
© Kawneer Company, Inc., 2011

560 INSULCLAD® DOOR

SCALE 3" = 1'-0"

OPTIONAL CROSS RAILS
(260, 360, AND 560 DOORS)

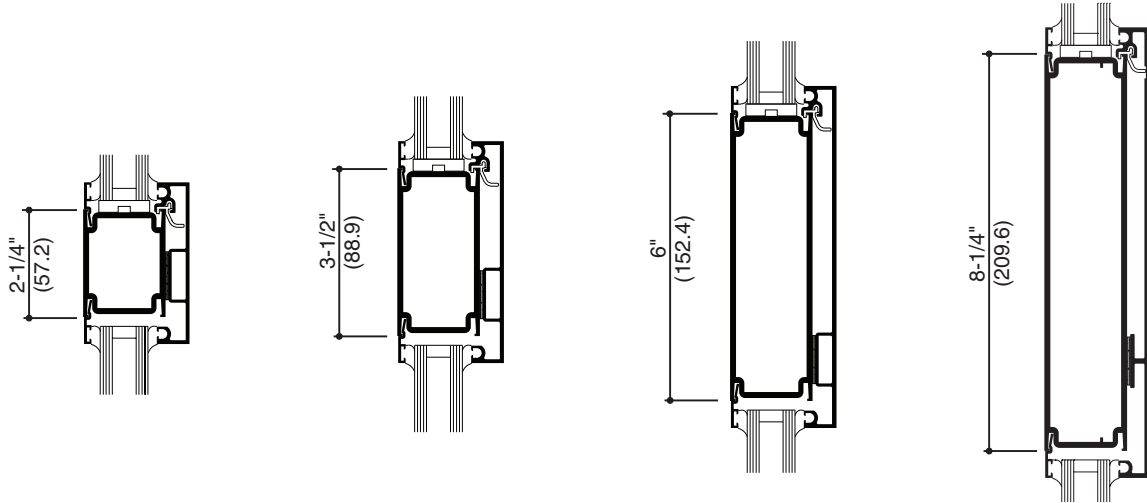

NOTE: Cross Rails were not used in the Thermal Test Reports.

OPTIONAL BOTTOM RAIL
(260, 360, AND 560 DOORS)

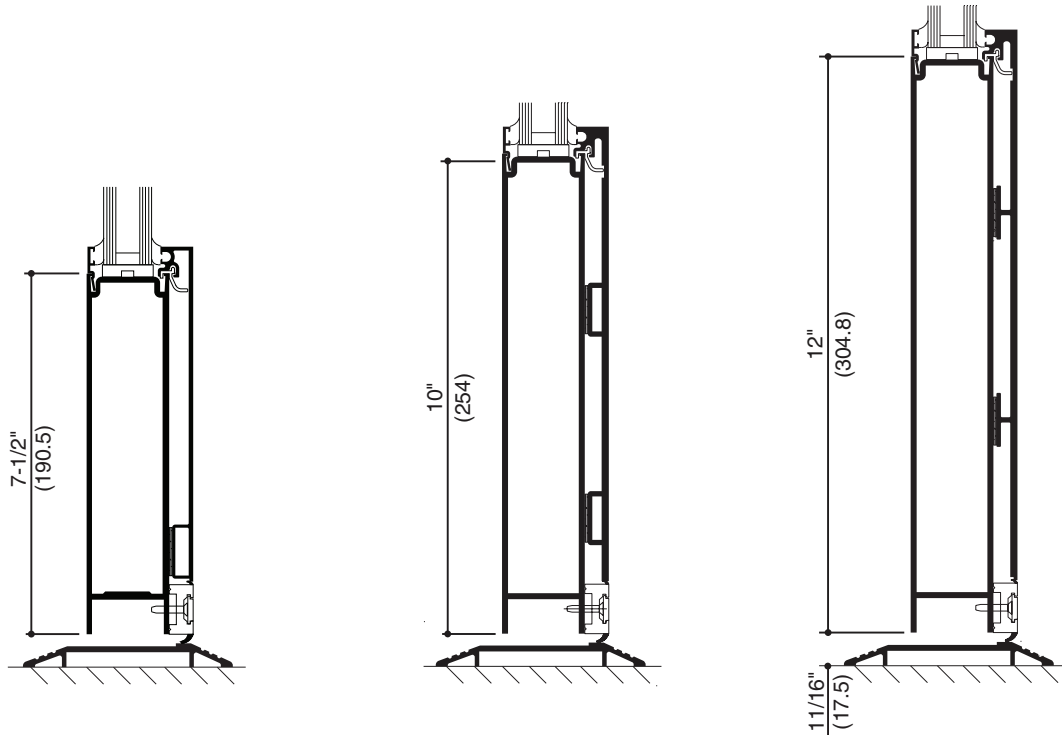

Laws and building and safety codes governing the design and use of glazed entrance, window, and curtain wall products vary widely. Kawneer does not control the selection of product configurations, operating hardware, or glazing materials, and assumes no responsibility therefor.

Kawneer reserves the right to change configuration without prior notice when deemed necessary for product improvement.
© Kawneer Company, Inc., 2011

HINGES AND PIVOTS

BUTT HINGES	Kawneer standard 4-1/2" x 4" ball bearing NRP butts. 1-1/2 Pair butts standard for doors 7'-3" (2210) or less in height. 2 Pair butts required for doors over 7'-3" (2210) high.
OFFSET PIVOTS	Kawneer standard top and bottom pivots for doors 7'-0" (2134) or less in height. Intermediate pivot required for doors over 7'-0" (2134) high.

DOOR CLOSERS

Consult factory for information concerning closer applications not listed.

SURFACE OVERHEAD	Norton 1601/1601 BF adjustable standard Kawneer closer. LCN Super Smoothee. LCN 1260 adjustable.
CONCEALED OVERHEAD	Single Acting offset arm COC or LCN concealed closer (requires non-thermal/tubular T-bar).
FLOOR CLOSER	Rixson 27 Series. single acting, offset pivot.

DOOR HOLDERS

Top rail surface mount for use with floor closers only.
Consult factory for other door holder requirements.

SURFACE HOLDER	Glynn Johnson GJ 90M. Rixson Checkmate No. 9.
-----------------------	--

LOCKS & LATCHES

See Page 11 for standard mounting heights.

DEADLOCK	<p>For Single Doors and Pairs of Doors Adams Rite MS-1850A. Adams Rite MS-1850A-505 Hookbolt.</p> <p>For Pairs of Doors Kawneer Flushbolts (Pair) for inactive leaf. Kawneer CONTROLLER™ Locking System.</p>
DEADLATCH	Adams Rite 4510. Adams Rite 1893.

Select inside operating lever from the following:

- Adams Rite 4560-09 Lever Handle 3-1/2" (88.9).
- Adams Rite 4565-11 Lever Handle 1-1/2" (38.1)
- Adams Rite Paddle for 4510 & 1893.

PUSH-PULLS

Architects Classic style CO-9 Pull and CP-II Push Bar.
Architects Classic style CO-9 Pull and CP Push Bar.
Architects Classic style CO-12 Pull and CP-II Push Bar.
Architects Classic style CO-12 Pull and CP Push Bar
Architects Classic style CO-9/CO-9 Pulls.
Architects Classic style CO-12/CO-12 Pulls.

Note: Refer to Hardware Section for complete description of hardware listed above.

Laws and building and safety codes governing the design and use of glazed entrance, window, and curtain wall products vary widely. Kawneer does not control the selection of product configurations, operating hardware, or glazing materials, and assumes no responsibility therefor.

Kawneer reserves the right to change configuration without prior notice when deemed necessary for product improvement.

© Kawneer Company, Inc., 2011

EXIT DEVICES



CONCEALED ROD... Dor-O-Matic/Falcon 1690 Standard Kawneer Device
 Dor-O-Matic/Falcon 1690 EL Standard Kawneer Device
 Dor-O-Matic/Falcon 1990

RIM TYPE..... Dor-O-Matic/Falcon 1790 Standard Kawneer Device
 Dor-O-Matic/Falcon 1790 EL Standard Kawneer Device
 Dor-O-Matic/Falcon 2090

REMOVABLE MULLION ① For Pair of doors with rim devices.

NOTE: Mullion Stabilizers recommended below both latch strikes.

EXIT DEVICE PULLS

ARCHITECTS CLASSIC - Style CO-9

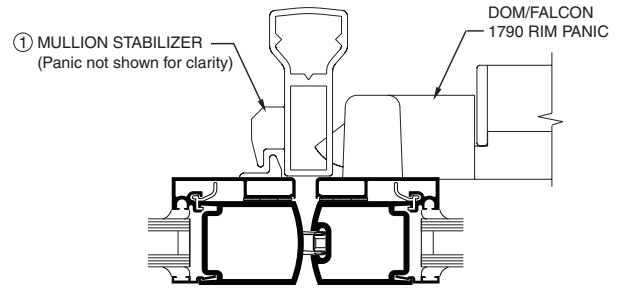

Dor-O-Matic/Falcon
 REMOVABLE MULLION

HARDWARE MOUNTING HEIGHTS (STANDARD LOCATIONS MEASURED FROM BOTTOM OF DOOR)

WITH
 STANDARD
 LOCKS

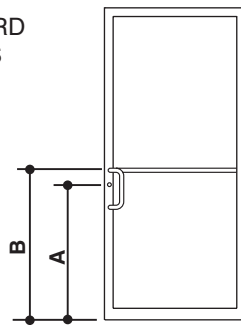

WITH
 Dor-O-Matic/Falcon
 1690/1790
 EXIT DEVICES

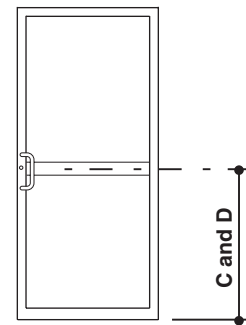

Dimension	A	B	C	D
HARDWARE ITEM	DEADLOCK/LATCH	PUSH BAR/PULL	1690 TOUCH BAR	1790 TOUCH BAR
MEASURED TO	☉ OF CYLINDER	☉ OF PUSH BAR	☉ OF TOUCH BAR	☉ OF TOUCH BAR
HEIGHT	40-13/16" (1036.6)	44-5/16" (1125.5)	40-5/8" (1031.9)	41-5/16" (1049.4)

MAXIMUM DOOR OPENING SIZES (Non-standard doors)

Single Doors: 3'-6" x 8'-0" (1067 x 2438) per door leaf

Pairs of doors: 7'-0" x 8'-0" (2134 x 2438) per pair

KEY DIMENSIONS FOR DOORS AND FRAMES

Door Opening Size	TRIFAB® VG 451T CENTER O.A. Frame Size (No Transom)
3'-1/2" x 7'-0"	3'-4-1/2" x 7'-2"
3'-6" x 7'-0"	3'-10" x 7'-2"
6'-0" x 7'-0"	6'-4" x 7'-2"

NOTE: For masonry opening dimensions, add 1/2" (12.7) to overall frame widths and 1/4" (6.4) to overall frame heights.

Laws and building and safety codes governing the design and use of glazed entrance, window, and curtain wall products vary widely. Kawneer does not control the selection of product configurations, operating hardware, or glazing materials, and assumes no responsibility therefor.

Kawneer reserves the right to change configuration without prior notice when deemed necessary for product improvement.

© Kawneer Company, Inc., 2011

TEST SPECIMEN

Description

Test entrance consisted of a single 3'-0" x 7'-0" (914 x 2134) Insulclad 260 door glazed with 1" (25.4) thick double pane insulating glass and hung in a Trifab® VG 451T Center frame. Full Sealair® weatherstripping was used at door perimeter.

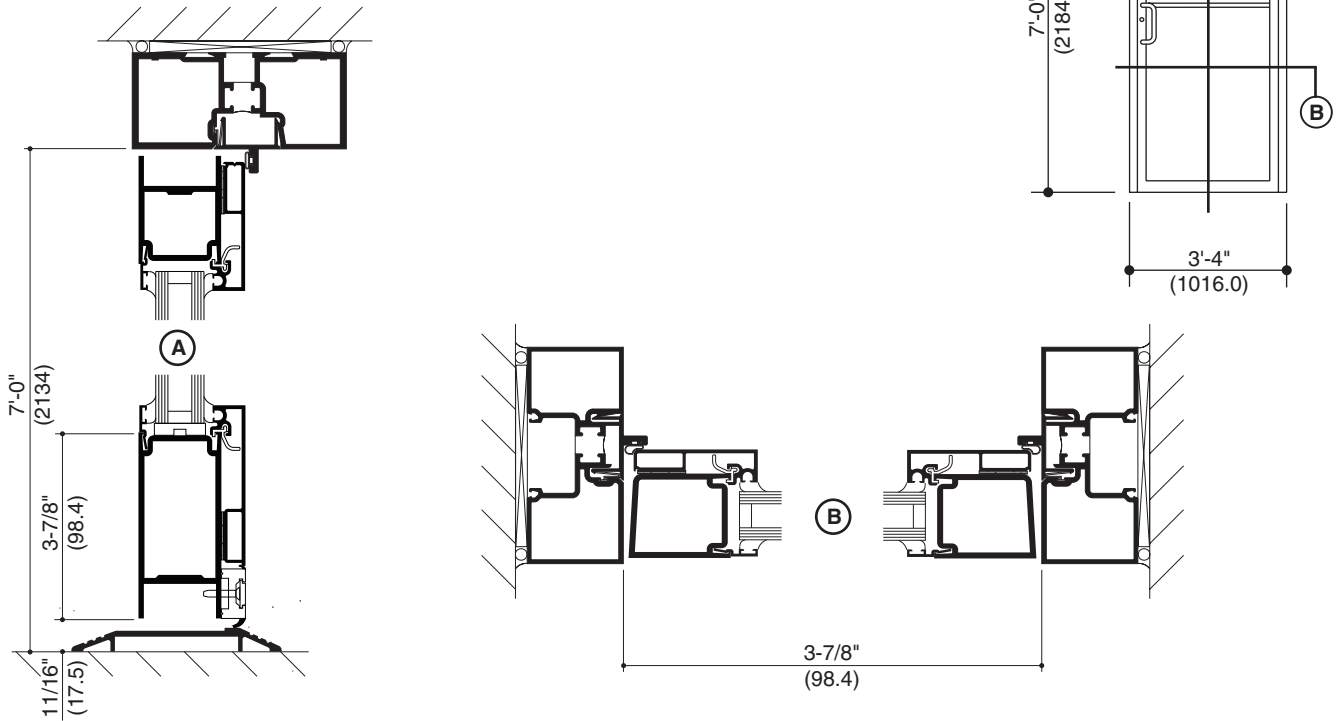

Laws and building and safety codes governing the design and use of glazed entrance, window, and curtain wall products vary widely. Kawneer does not control the selection of product configurations, operating hardware, or glazing materials, and assumes no responsibility therefor.

Kawneer reserves the right to change configuration without prior notice when deemed necessary for product improvement.

© Kawneer Company, Inc., 2011

WINDLOAD ON ENTRANCE FRAMING

Charted windload curves are based on allowable stress for aluminum of 15,152 PSI and a L/175 deflection ratio and, in all cases represent the limiting values. Dimensional limits at the stated windloads are for door frame members anchored only at the ends.

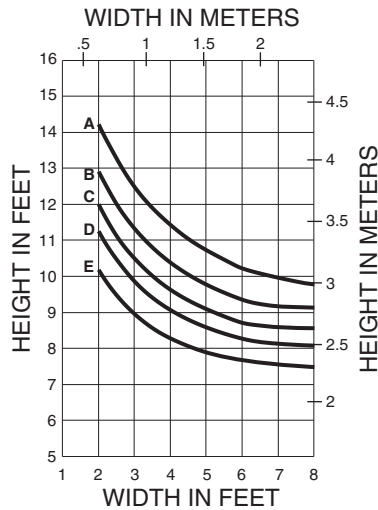

- A = 15 PSF (720 Pa)
- B = 20 PSF (960 Pa)
- C = 25 PSF (1200 Pa)
- D = 30 PSF (1440 Pa)

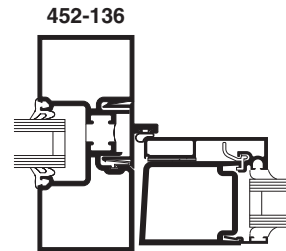

DEADLOAD ON TRANSOM BAR

Height limitations for transom glass over a doorway are based on a maximum 1/16" (1.6) mid-point deflection of a transom bar supporting 1" (25.4) thick double 1/4" (6.4) pane insulating glass bearing on two setting blocks placed at the 1/4-points (i.e. one fourth of the span as measured from each end). To determine height limitations for other types of insulating glass multiply the allowable glass height from the chart times 1.33 for units made with two panes of 3/16" (4.8) thick glass or times 2.0 for units made with two 1/8" (3.2) panes.

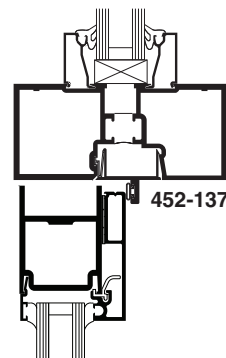
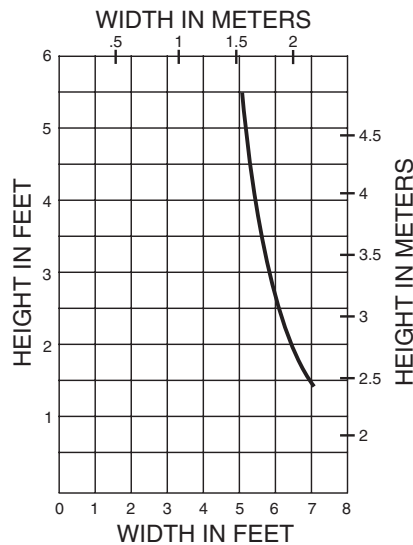

Laws and building and safety codes governing the design and use of glazed entrance, window, and curtain wall products vary widely. Kawneer does not control the selection of product configurations, operating hardware, or glazing materials, and assumes no responsibility therefor.

Kawneer reserves the right to change configuration without prior notice when deemed necessary for product improvement.
© Kawneer Company, Inc., 2011

Project Specific U-Factor Example Calculation

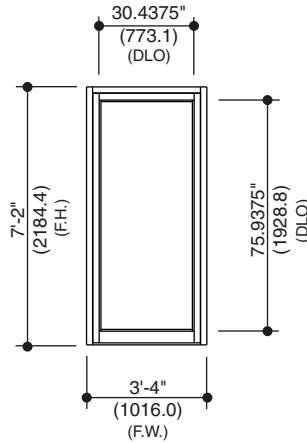

Note: 260 Door shown for example

- Example Glass U-Factor = 0.42 Btu/hr • ft² • °F
- Total Daylight Opening = 30.4375" x 75.9375" = 16.05 ft²
- Total Projected Area = 3'-4" x 7'-2" = 23.9 ft²
- Percent of Glass = (Total Daylight Opening ÷ Total Projected Area)100
= (16.05 ÷ 23.9)100 = 67%

System U-factor vs Percent of Glass Area

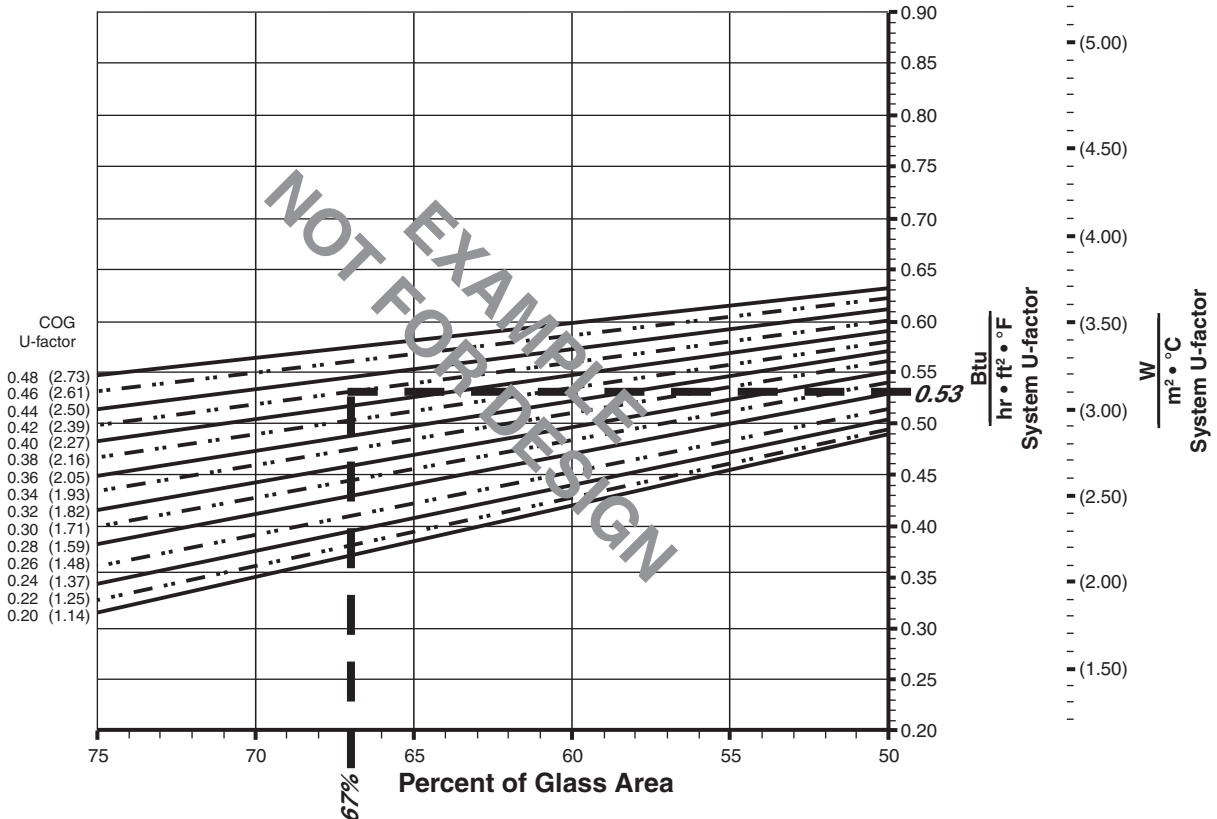

Based on 67% glass and center of glass (COG) U-factor of 0.42
System U-factor is equal to 0.53 Btu/hr • ft² • °F

Laws and building and safety codes governing the design and use of glazed entrance, window, and curtain wall products vary widely. Kawneer does not control the selection of product configurations, operating hardware, or glazing materials, and assumes no responsibility therefor.

Kawneer reserves the right to change configuration without prior notice when deemed necessary for product improvement.
© Kawneer Company, Inc., 2011

260 INSULCLAD® DOOR - SINGLE LEAF

Note:

Values in parentheses are metric.
 COG = Center of Glass.
 Charts are generated per AMMA 507

System U-factor vs Percent of Glass Area

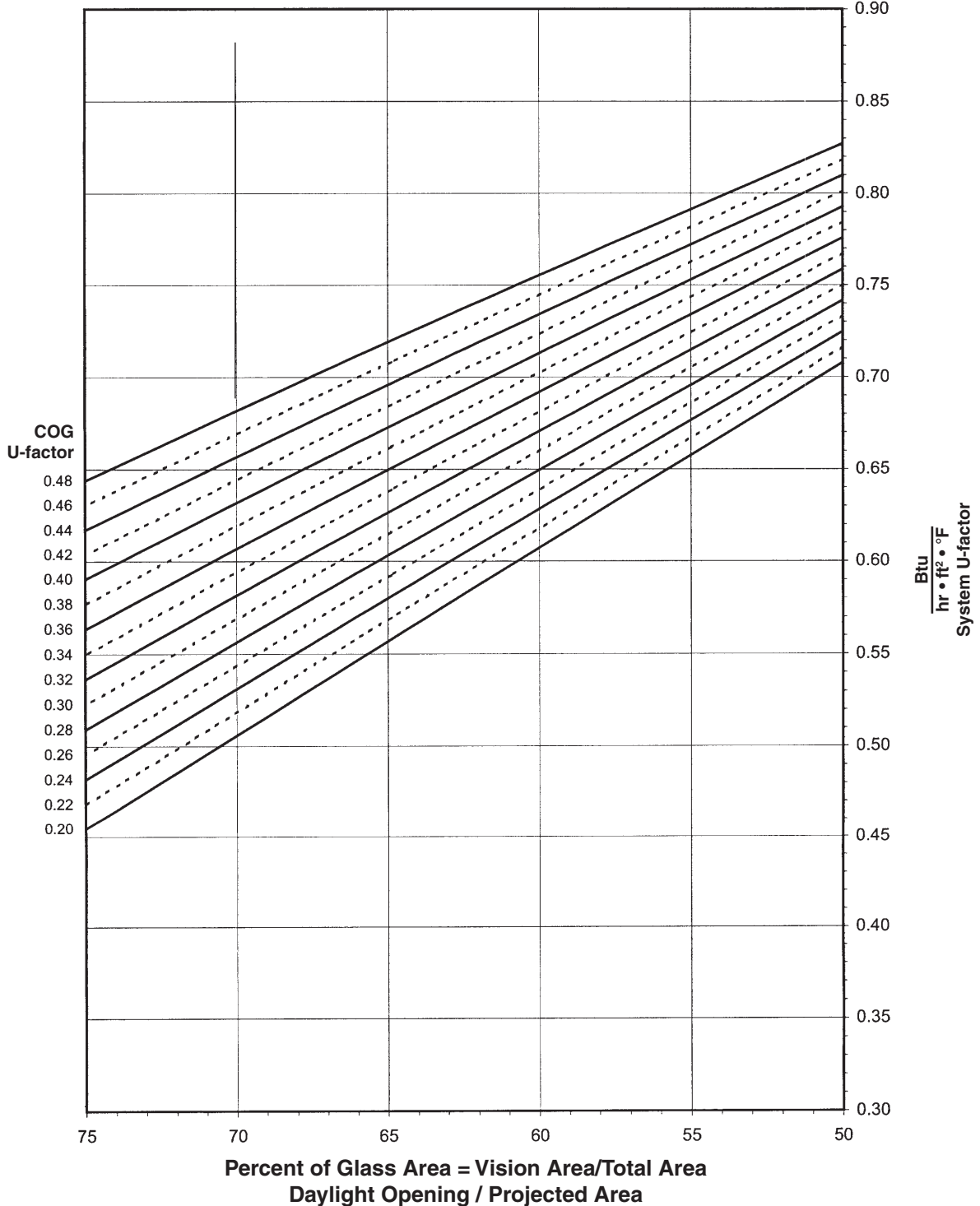

Notes for System U-factor, SHGC and VT charts:

For glass values that are not listed, linear interpolation is permitted.
 Glass properties are based on center of glass values and are obtained from your glass supplier.

Laws and building and safety codes governing the design and use of glazed entrance, window, and curtain wall products vary widely. Kawneer does not control the selection of product configurations, operating hardware, or glazing materials, and assumes no responsibility therefor.

Kawneer reserves the right to change configuration without prior notice when deemed necessary for product improvement.
 © Kawneer Company, Inc., 2011

260 INSULCLAD® DOOR - SINGLE LEAF

System Solar Heat Gain Coefficient (SHGC) vs Percent of Vision Area

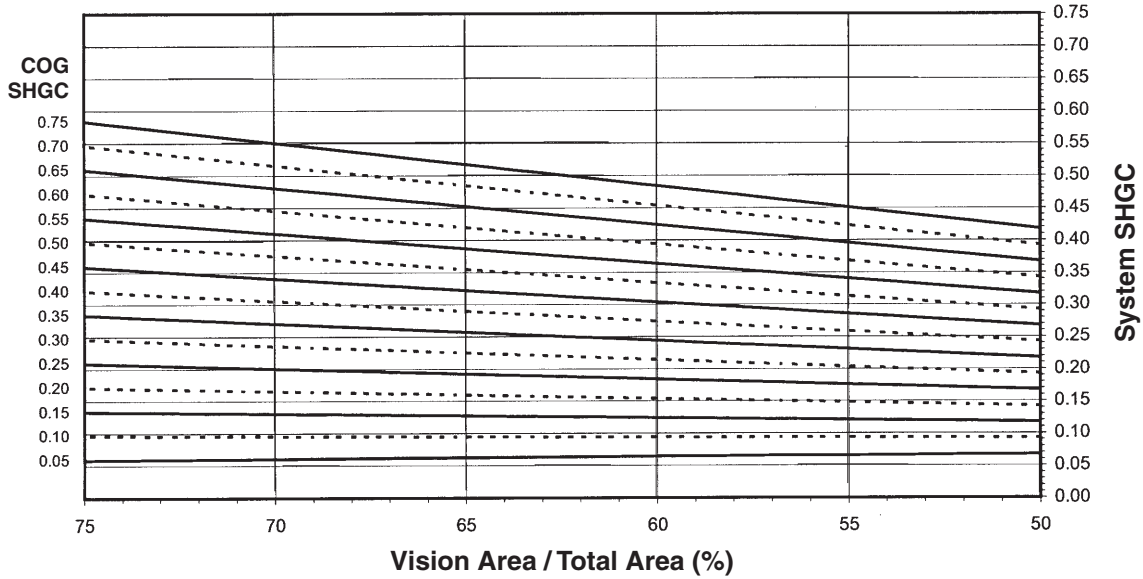

System Visible Transmittance (VT) vs Percent of Vision Area

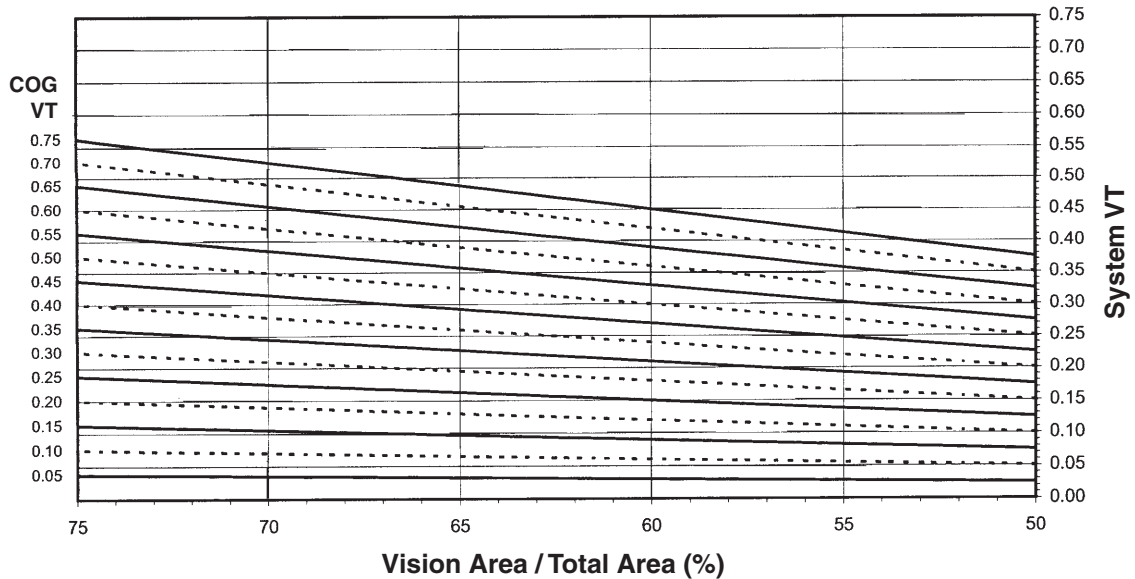

Laws and building and safety codes governing the design and use of glazed entrance, window, and curtain wall products vary widely. Kawneer does not control the selection of product configurations, operating hardware, or glazing materials, and assumes no responsibility therefor.

Kawneer reserves the right to change configuration without prior notice when deemed necessary for product improvement.
© Kawneer Company, Inc., 2011

260 INSULCLAD® DOOR - SINGLE LEAF

Thermal Transmittance¹ (BTU/hr • ft² • °F)

Glass U-Factor ³	Overall U-Factor ⁴
0.48	0.72
0.46	0.71
0.44	0.70
0.42	0.69
0.40	0.67
0.38	0.66
0.36	0.65
0.34	0.64
0.32	0.63
0.30	0.62
0.28	0.60
0.26	0.59
0.24	0.58
0.22	0.57
0.20	0.56

SHGC Matrix²

Glass SHGC ³	Overall SHGC ⁴
0.75	0.52
0.70	0.48
0.65	0.45
0.60	0.42
0.55	0.39
0.50	0.35
0.45	0.32
0.40	0.29
0.35	0.26
0.30	0.22
0.25	0.19
0.20	0.16
0.15	0.13
0.10	0.09
0.05	0.06

Visible Transmittance²

Glass VT ³	Overall VT ⁴
0.75	0.49
0.70	0.45
0.65	0.42
0.60	0.39
0.55	0.36
0.50	0.32
0.45	0.29
0.40	0.26
0.35	0.23
0.30	0.19
0.25	0.16
0.20	0.13
0.15	0.10
0.10	0.06
0.05	0.03

NOTE: For glass values that are not listed, linear interpolation is permitted.

1. U-Factors are determined in accordance with NFRC 100.
2. SHGC and VT values are determined in accordance with NFRC 200.
3. Glass properties are based on center of glass values and are obtained from your glass supplier.
4. Overall U-Factor, SHGC, and VT Matrices are based on the standard NFRC specimen size of 1000mm wide by 2000mm high (39-3/8" x 78-3/4").

Laws and building and safety codes governing the design and use of glazed entrance, window, and curtain wall products vary widely. Kawneer does not control the selection of product configurations, operating hardware, or glazing materials, and assumes no responsibility therefor.

Kawneer reserves the right to change configuration without prior notice when deemed necessary for product improvement.
© Kawneer Company, Inc., 2011

360 INSULCLAD® DOOR - SINGLE LEAF

Note:

Values in parentheses are metric.

COG = Center of Glass.

Charts are generated per AMMA 507

System U-factor vs Percent of Glass Area

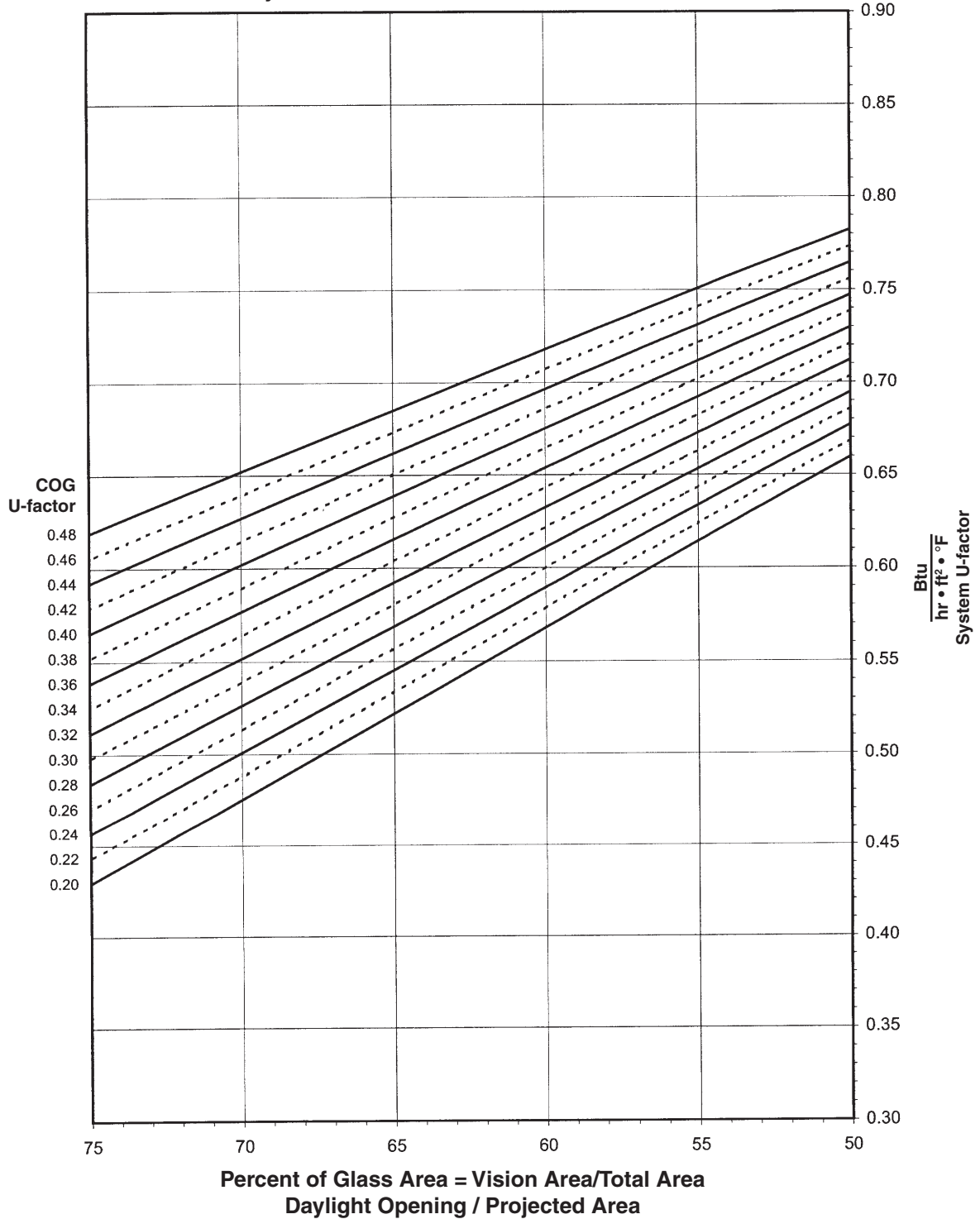

Notes for System U-factor, SHGC and VT charts:

For glass values that are not listed, linear interpolation is permitted.

Glass properties are based on center of glass values and are obtained from your glass supplier.

Laws and building and safety codes governing the design and use of glazed entrance, window, and curtain wall products vary widely. Kawneer does not control the selection of product configurations, operating hardware, or glazing materials, and assumes no responsibility therefor.

Kawneer reserves the right to change configuration without prior notice when deemed necessary for product improvement.

© Kawneer Company, Inc., 2011

360 INSULCLAD® DOOR - SINGLE LEAF

System Solar Heat Gain Coefficient (SHGC) vs Percent of Vision Area

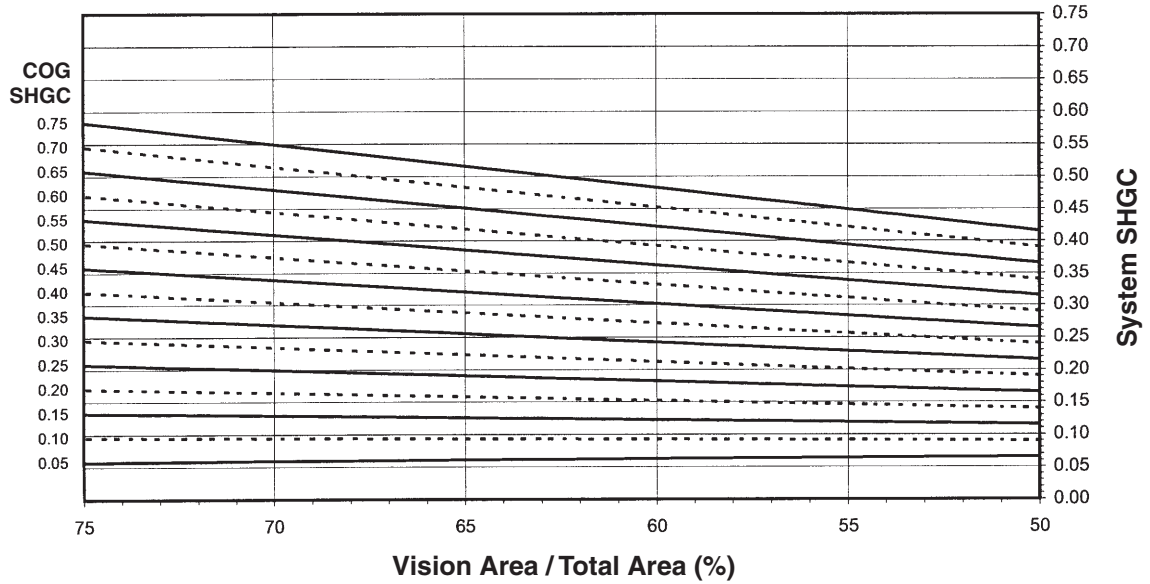

System Visible Transmittance (VT) vs Percent of Vision Area

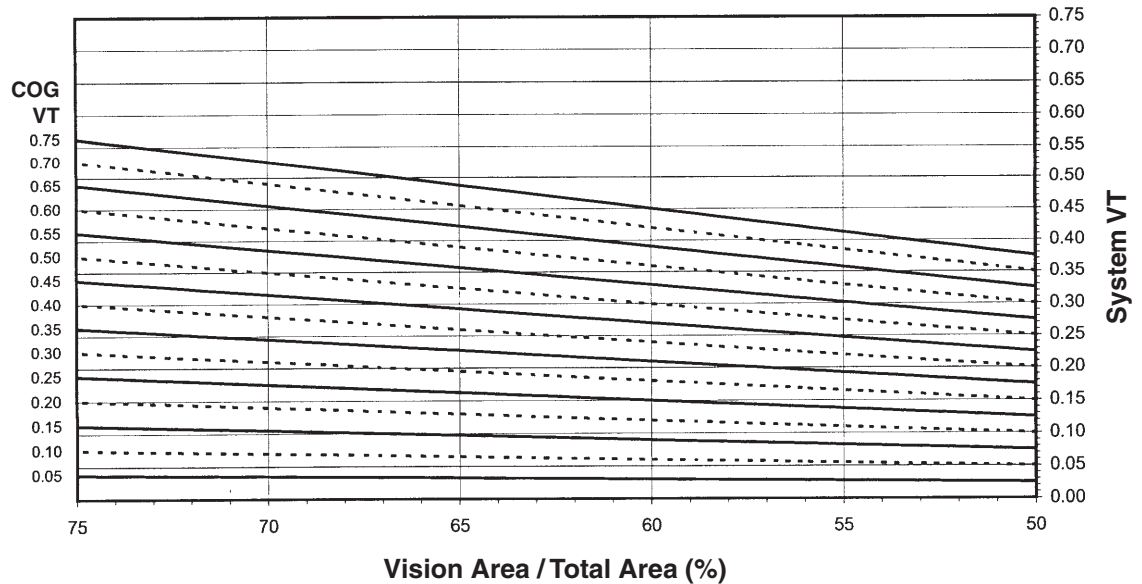

Laws and building and safety codes governing the design and use of glazed entrance, window, and curtain wall products vary widely. Kawneer does not control the selection of product configurations, operating hardware, or glazing materials, and assumes no responsibility therefor.

Kawneer reserves the right to change configuration without prior notice when deemed necessary for product improvement.
© Kawneer Company, Inc., 2011

360 INSULCLAD® DOOR - SINGLE LEAF

Thermal Transmittance¹ (BTU/hr • ft² • °F)

Glass U-Factor ³	Overall U-Factor ⁴
0.48	0.75
0.46	0.74
0.44	0.73
0.42	0.72
0.40	0.71
0.38	0.70
0.36	0.69
0.34	0.68
0.32	0.67
0.30	0.66
0.28	0.65
0.26	0.64
0.24	0.63
0.22	0.62
0.20	0.61

SHGC Matrix²

Glass SHGC ³	Overall SHGC ⁴
0.75	0.45
0.70	0.42
0.65	0.40
0.60	0.37
0.55	0.34
0.50	0.31
0.45	0.29
0.40	0.26
0.35	0.23
0.30	0.20
0.25	0.17
0.20	0.15
0.15	0.12
0.10	0.09
0.05	0.06

Visible Transmittance²

Glass VT ³	Overall VT ⁴
0.75	0.42
0.70	0.39
0.65	0.36
0.60	0.33
0.55	0.31
0.50	0.28
0.45	0.25
0.40	0.22
0.35	0.19
0.30	0.17
0.25	0.14
0.20	0.11
0.15	0.08
0.10	0.06
0.05	0.03

NOTE: For glass values that are not listed, linear interpolation is permitted.

1. U-Factors are determined in accordance with NFRC 100.
2. SHGC and VT values are determined in accordance with NFRC 200.
3. Glass properties are based on center of glass values and are obtained from your glass supplier.
4. Overall U-Factor, SHGC, and VT Matrices are based on the standard NFRC specimen size of 1000mm wide by 2000mm high (39-3/8" x 78-3/4").

Laws and building and safety codes governing the design and use of glazed entrance, window, and curtain wall products vary widely. Kawneer does not control the selection of product configurations, operating hardware, or glazing materials, and assumes no responsibility therefor.

Kawneer reserves the right to change configuration without prior notice when deemed necessary for product improvement.

© Kawneer Company, Inc., 2011

560 INSULCLAD® DOOR - SINGLE LEAF

Note:

Values in parentheses are metric.

COG = Center of Glass.

Charts are generated per AMMA 507

System U-factor vs Percent of Glass Area

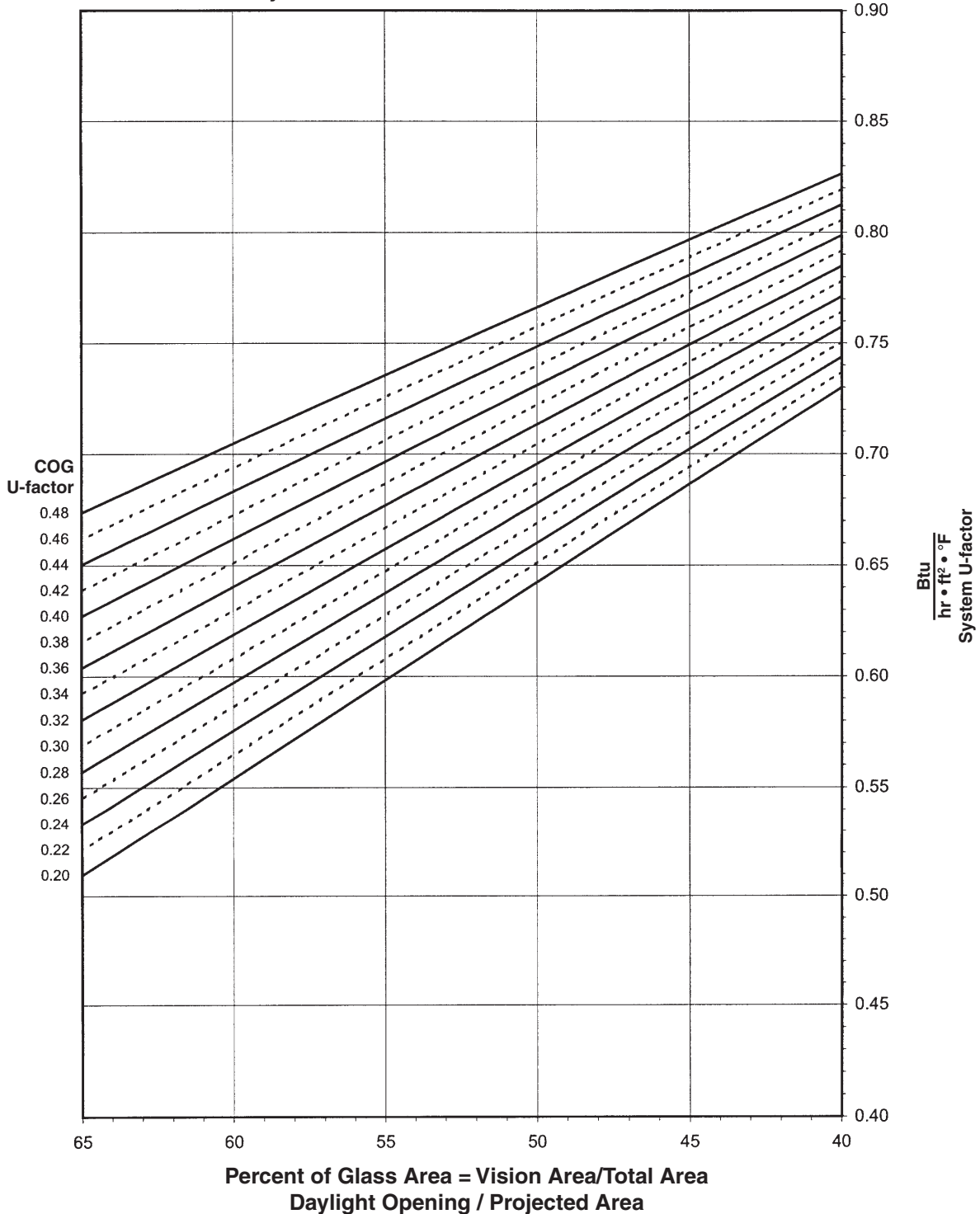

Notes for System U-factor, SHGC and VT charts:

For glass values that are not listed, linear interpolation is permitted.

Glass properties are based on center of glass values and are obtained from your glass supplier.

Laws and building and safety codes governing the design and use of glazed entrance, window, and curtain wall products vary widely. Kawneer does not control the selection of product configurations, operating hardware, or glazing materials, and assumes no responsibility therefor.

Kawneer reserves the right to change configuration without prior notice when deemed necessary for product improvement.

© Kawneer Company, Inc., 2011

560 INSULCLAD® DOOR - SINGLE LEAF

System Solar Heat Gain Coefficient (SHGC) vs Percent of Vision Area

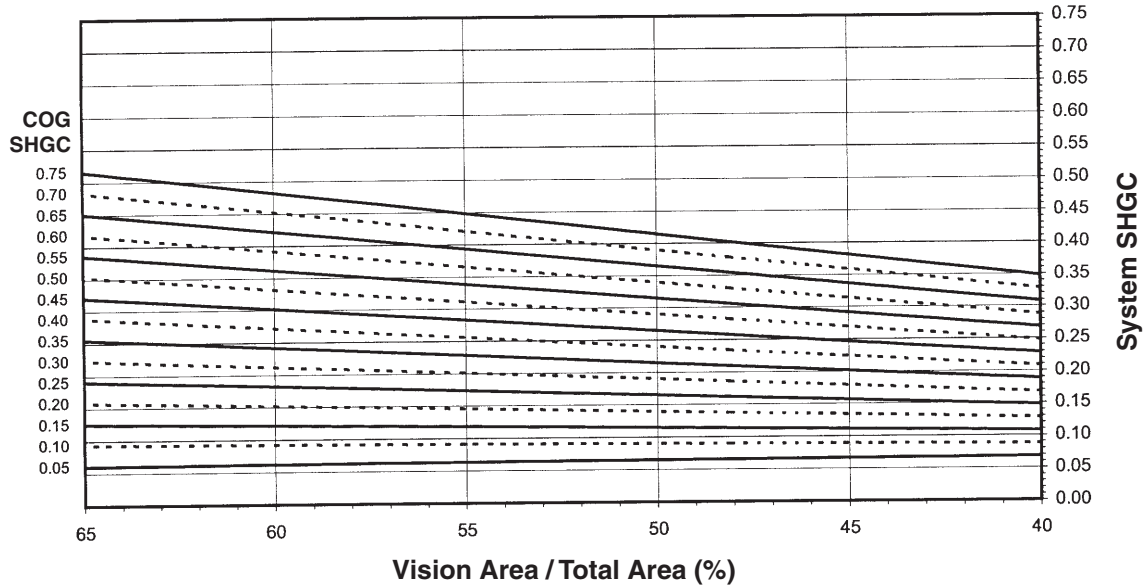

System Visible Transmittance (VT) vs Percent of Vision Area

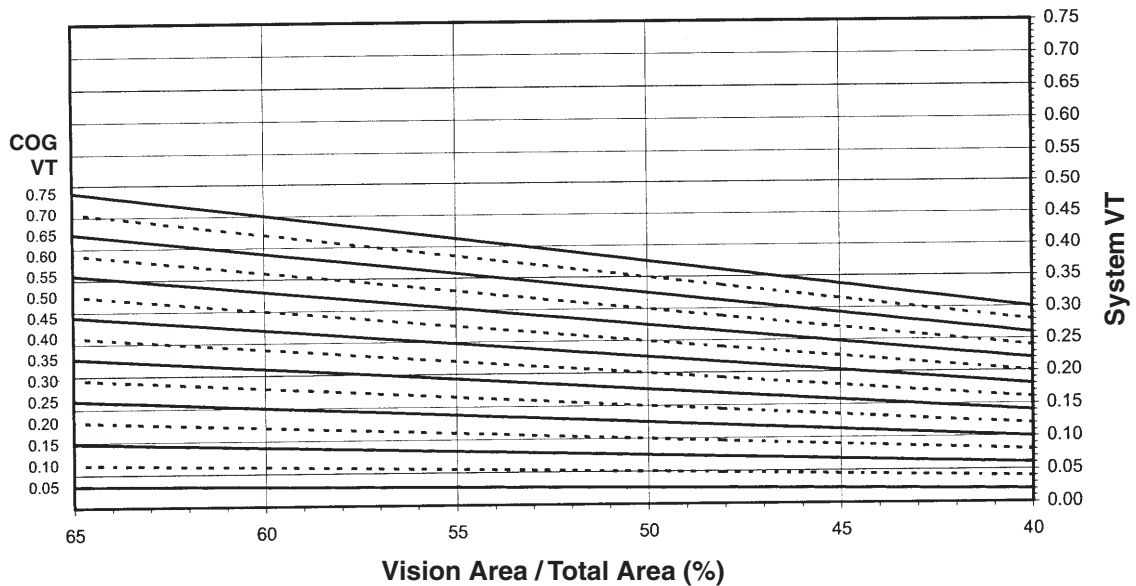

Laws and building and safety codes governing the design and use of glazed entrance, window, and curtain wall products vary widely. Kawneer does not control the selection of product configurations, operating hardware, or glazing materials, and assumes no responsibility therefor.

Kawneer reserves the right to change configuration without prior notice when deemed necessary for product improvement.
© Kawneer Company, Inc., 2011

560 INSULCLAD® DOOR - SINGLE LEAF

Thermal Transmittance¹ (BTU/hr • ft² • °F)

Glass U-Factor ³	Overall U-Factor ⁴
0.48	0.72
0.46	0.77
0.44	0.76
0.42	0.75
0.40	0.74
0.38	0.74
0.36	0.73
0.34	0.72
0.32	0.71
0.30	0.70
0.28	0.69
0.26	0.68
0.24	0.68
0.22	0.67
0.20	0.66

SHGC Matrix²

Glass SHGC ³	Overall SHGC ⁴
0.75	0.40
0.70	0.38
0.65	0.35
0.60	0.33
0.55	0.31
0.50	0.28
0.45	0.26
0.40	0.23
0.35	0.21
0.30	0.19
0.25	0.16
0.20	0.14
0.15	0.11
0.10	0.09
0.05	0.07

Visible Transmittance²

Glass VT ³	Overall VT ⁴
0.75	0.36
0.70	0.34
0.65	0.31
0.60	0.29
0.55	0.26
0.50	0.24
0.45	0.22
0.40	0.19
0.35	0.17
0.30	0.14
0.25	0.12
0.20	0.10
0.15	0.07
0.10	0.05
0.05	0.02

NOTE: For glass values that are not listed, linear interpolation is permitted.

1. U-Factors are determined in accordance with NFRC 100.
2. SHGC and VT values are determined in accordance with NFRC 200.
3. Glass properties are based on center of glass values and are obtained from your glass supplier.
4. Overall U-Factor, SHGC, and VT Matrices are based on the standard NFRC specimen size of 1000mm wide by 2000mm high (39-3/8" x 78-3/4").

Laws and building and safety codes governing the design and use of glazed entrance, window, and curtain wall products vary widely. Kawneer does not control the selection of product configurations, operating hardware, or glazing materials, and assumes no responsibility therefor.

Kawneer reserves the right to change configuration without prior notice when deemed necessary for product improvement.

© Kawneer Company, Inc., 2011

Laws and building and safety codes governing the design and use of glazed entrance, window, and curtain wall products vary widely. Kawneer does not control the selection of product configurations, operating hardware, or glazing materials, and assumes no responsibility therefor.

Kawneer reserves the right to change configuration without prior notice when deemed necessary for product improvement.

© Kawneer Company, Inc., 2011